

# EAO – Your Expert Partner for Human Machine Interfaces

## 704.410.0 - Selector switch actuator 2 positions, short lever

### 704.410.0 - Selector switch actuator 2 positions, short lever

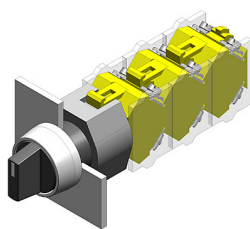

*Attention: The preview is based on a sample product. This can differ from your current configuration.*

#### Mounting

|                  |           |
|------------------|-----------|
| Mounting cut-out | Ø 22,3 mm |
| Design           | raised    |

#### Front

|                      |         |
|----------------------|---------|
| Front dimension      | Ø 29 mm |
| Front shape          | round   |
| Front bezel colour   | grey    |
| Front bezel material | Plastic |

#### Other Attributes

|        |          |
|--------|----------|
| Weight | 0,034 kg |
|--------|----------|

#### Operating-/Indication part

|                    |                  |
|--------------------|------------------|
| Lever material     | Plastic          |
| Lever colour       | black            |
| Switching angle    |                  |
| Lever illumination | non-illuminative |
| Lever shape        | short            |

#### IP-Rating

|                  |      |
|------------------|------|
| Front protection | IP65 |
|------------------|------|

#### Actuator

|                  |  |
|------------------|--|
| Switching action |  |
|------------------|--|

#### Switching element

|                                   |   |
|-----------------------------------|---|
| Rotary positions                  | 2 |
| max. number of switching elements | 3 |

#### Function

|                 |  |
|-----------------|--|
| Selector switch |  |
|-----------------|--|

# EAO – Your Expert Partner for Human Machine Interfaces

## 704.410.0 - Selector switch actuator 2 positions, short lever

### Dimensions

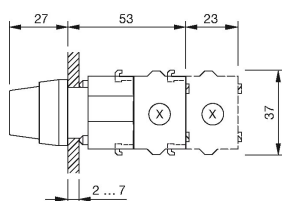

X = Screw terminal

### Mounting cut-outs

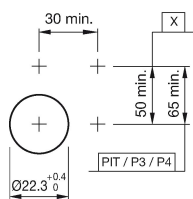

PIT = Push-in terminal

### Wiring diagram



### Switching positions

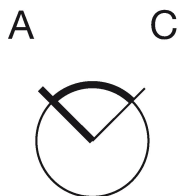

### Additional information

Max. 3 switching elements can be clipped on

### Legend

Switching action: A = Rest, C = Maintained