

# E43301

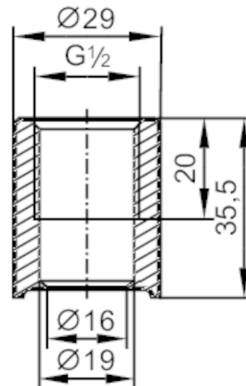

## Welding adapter for process sensors

ADAPT G1/2-WELDING FOR PIPE



EC 1935/2004 EHEDG Tested FCM FDA

Application	
Design	for pipes
Pressure rating [bar]	50
Note on pressure rating	for the connection sensor - adapter
Tests / approvals	
Pressure Equipment Directive	A possible classification to PED depends on the application and has to be carried out by the user / operator.
Safety instructions	The compatibility between medium and product material has to be checked in all applications.
Mechanical data	
Weight [g]	162
Materials	stainless steel (316L/1.4435)
Sensor connection	G 1/2 sealing cone
Process connection	welding adapter DN25 (29 x 1,5); Maße gemäß DIN 11866; Reihe A DIN
Surface characteristics Ra/Rz of the wetted parts	0.4 / 4
Accessories	
Items supplied	O-rings:, FKM
Remarks	
Pack quantity	1 pcs.