

PLANAR SCHOTTKY BARRIER DIODE

PINNING

PIN	DESCRIPTION
1	Cathode
2	Anode

FEATURES

- Small surface mounting type
- Low reverse current and low forward voltage
- High reliability



■ Maximum Ratings and Electrical Characteristics, Single Diode @Ta=25°C

Parameter	Symbol	Limit	Unit
DC reverse voltage	V_R	30	V
Mean rectifying current	I_O	100	mA
Non-repetitive Peak forward surge current @ t=8.3ms	I_{FSM}	500	mA
Power dissipation	P_D	200	mW
Thermal Resistance Junction to Ambient	$R_{\theta JA}$	500	°C/W
Operating Junction Temperature Range	T_j	-40 ~ +125	°C
Storage Temperature Range	T_{stg}	-55 ~ +150	°C

■ Electrical Ratings @Ta=25°C

Parameter	Symbol	Test Condition	Min	Typ	Max	Unit
Reverse breakdown voltage	$V_{(BR)}$	$I_R=10\mu A$	30			V
Reverse current	I_R	$V_R=10V$			2	μA
Forward voltage	V_F	$I_F=10mA$			0.40	V
		$I_F=20mA$			0.45	V
		$I_F=100mA$			0.60	V
		$I_F=200mA$			0.70	V

Typical Characteristics

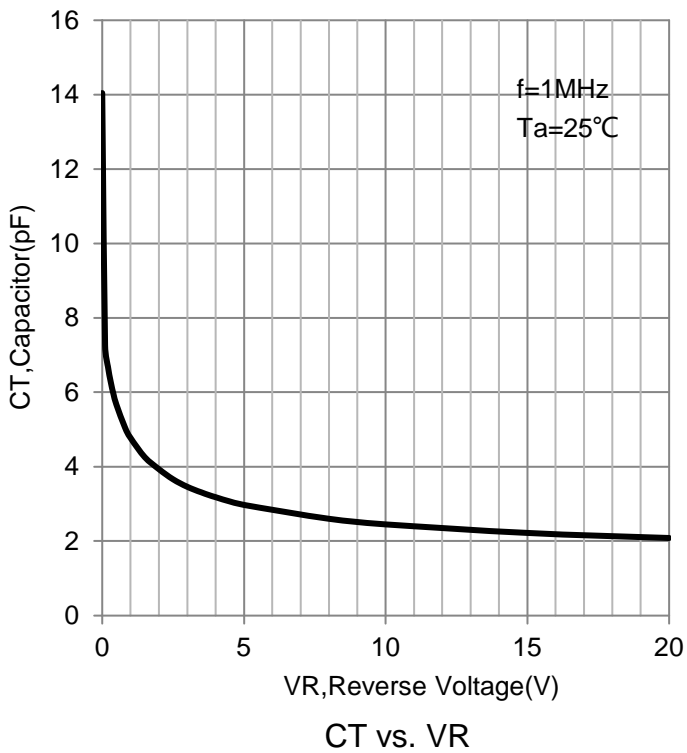
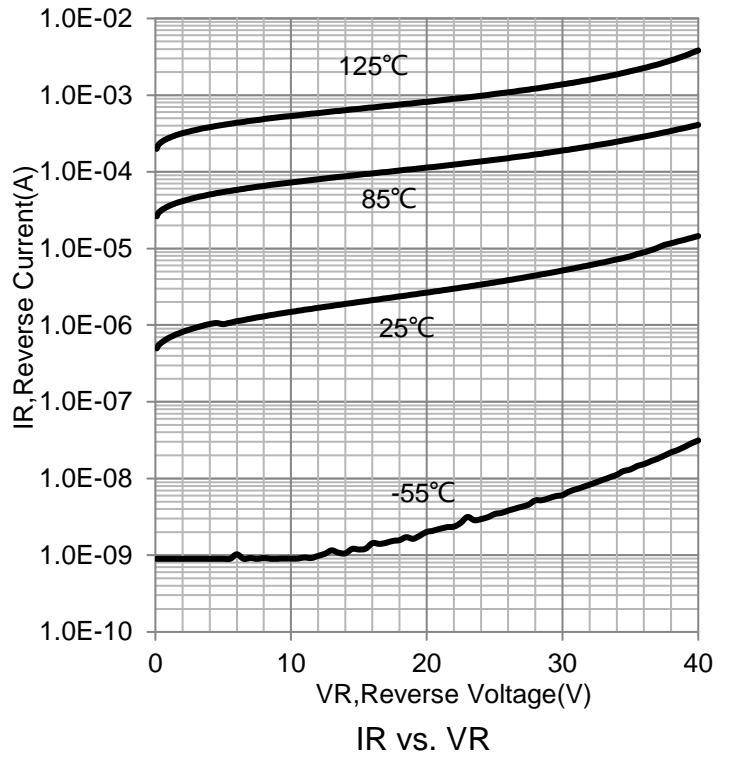
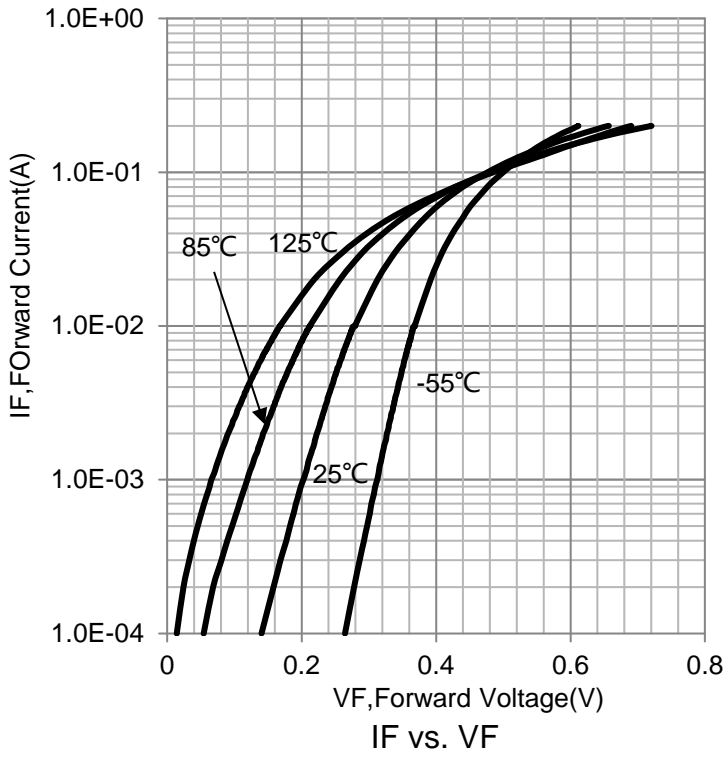

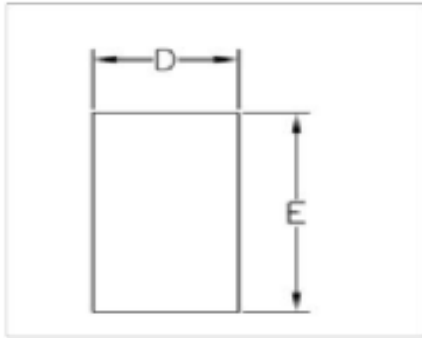
DFN1006-2L Package Outline Dimensions

TOP VIEW

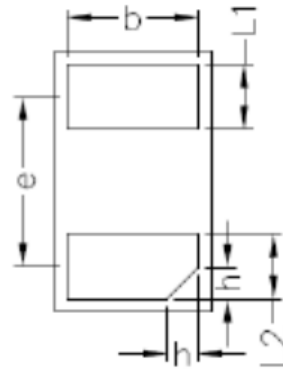

BOTTOM VIEW

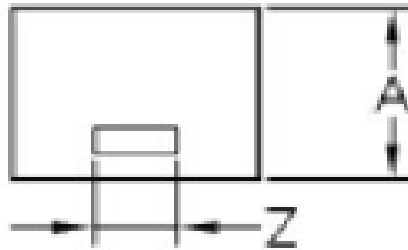

SIDE VIEW

Symbol	Dimensions In Millimeters		
	Min	Nom	Max
D	0.55	0.60	0.65
E	0.95	1.00	1.05
L1	0.20	0.25	0.30
L2	0.20	0.25	0.30
A	0.45	0.50	0.55
Z	0.15	0.20	0.25
b	0.45	0.50	0.55
e	0.64BSC		
h	0.07	0.12	0.17