

NO. OF CIRCUITS	DIM. "A"		DIM. "B"		ASSEMBLY MATERIAL NO. (STANDARD)	ASSEMBLY MATERIAL NO. (-50 OPT)
	mm	in	mm	in		
03	26.2	1.03	16.5	.65		386913503
08	67.4	2.66	57.8	2.28	386912308	

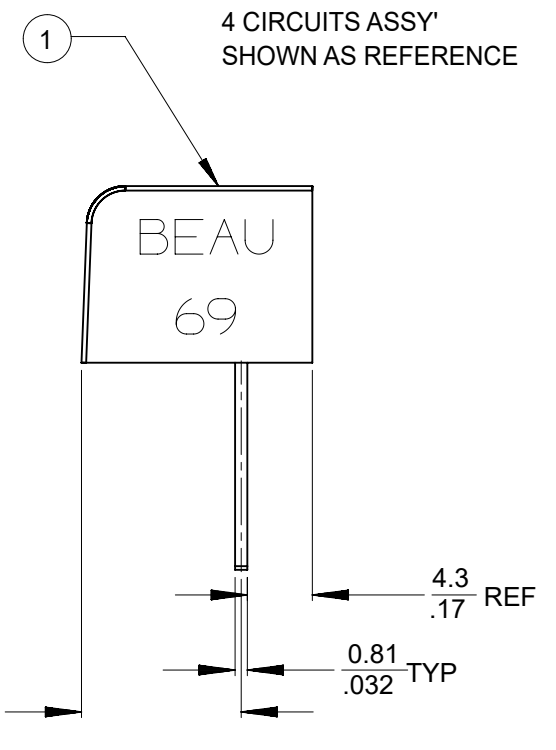
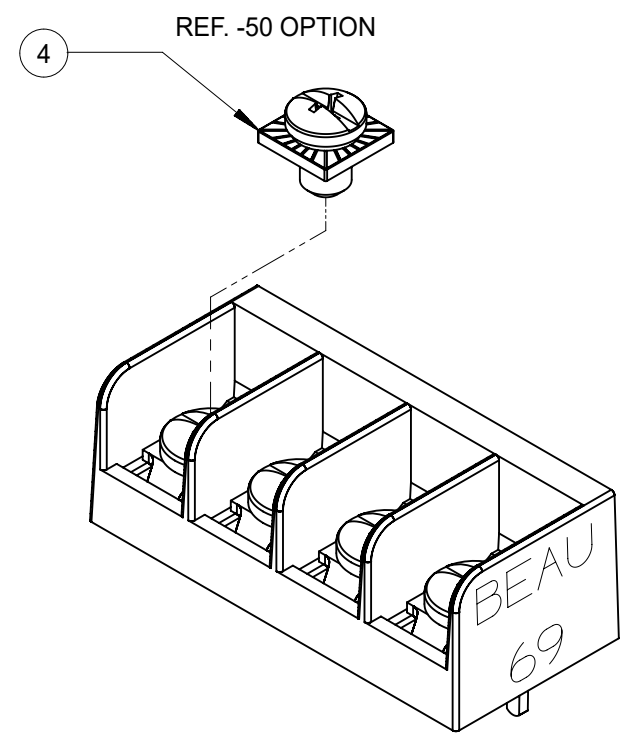
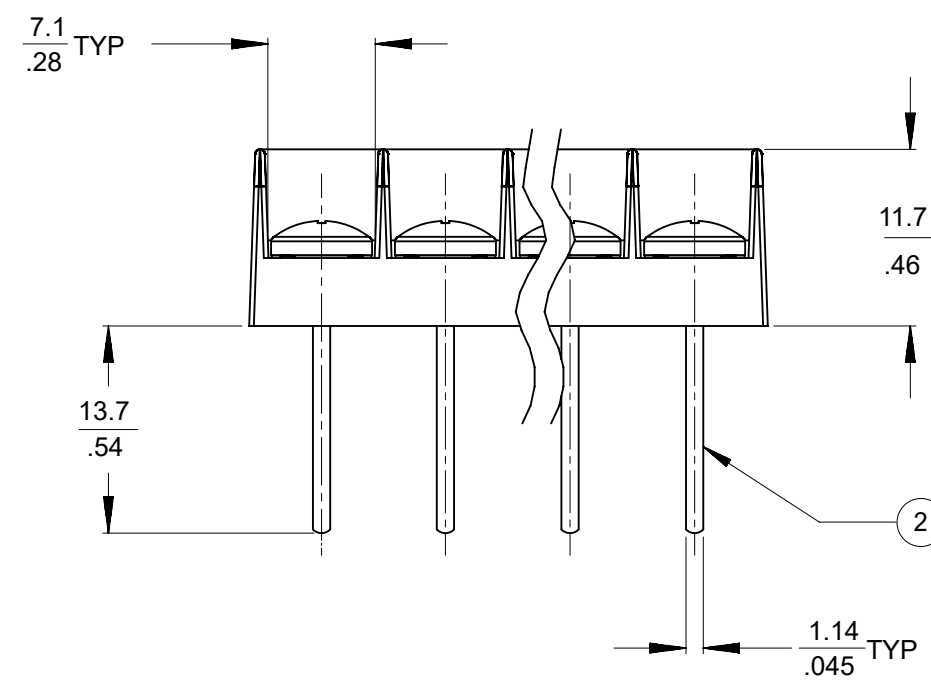
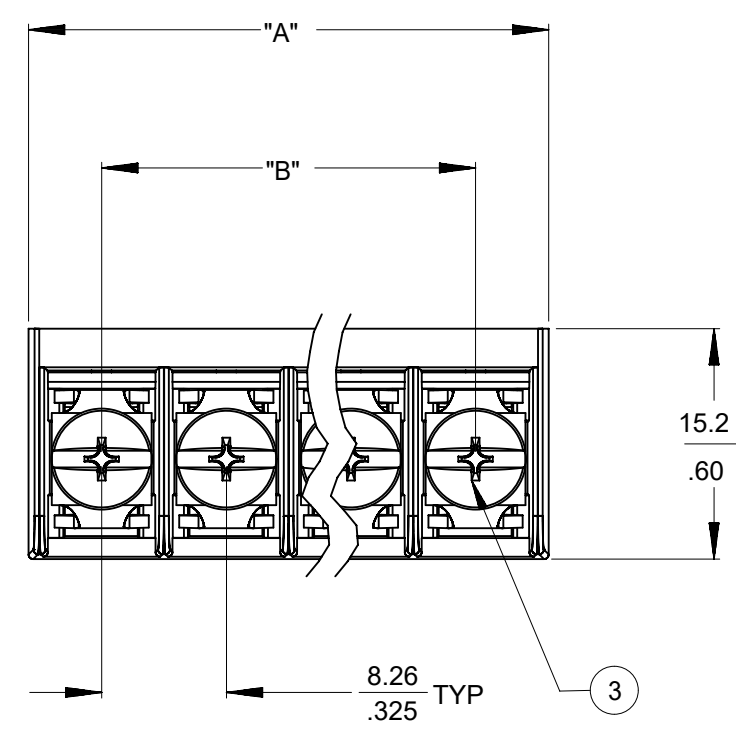

NOTES:
 1. MATERIAL: SEE TABLE
 2. FINISHES: SEE TABLE.
 3. "XX" REFERS TO THE QUANTITY OF CIRCUITS.
 4. ROHS COMPLIANT.

ITEM	QTY.	DESCRIPTION	MATERIAL NO.	ENGINEERING NO.
4	XX	SCREW #6-32X.155 PAN PHSLZN/BR/STEEL -50	STEEL	ZN, CLEAR CHROMATE
3	XX	SCREW #6-32X.160 PAN PHSLNI/BRASS (STD)	BRASS	NICKEL PLATE
2	XX	TERMINAL, PC	BRASS	TIN PLATE
1	1	INSULATOR	POLYESTER (PBT)	BLACK

DOCUMENT STATUS	P1	RELEASE DATE	2024/08/14	08:26:40
-----------------	----	--------------	------------	----------

PRE-RELEASE
 REFERENCE
 USE ONLY

THIS DRAWING CONTAINS INFORMATION THAT IS PROPRIETARY TO MOLEX ELECTRONIC TECHNOLOGIES, LLC AND SHOULD NOT BE USED WITHOUT WRITTEN PERMISSION											
DIMENSION UNITS mm/IN		SCALE 2:1		CURRENT REV DESC: REMOVED OBSOLETE PART NUMBERS AS PER PCN#515181				molex		8.26/.325 SR TRI-BARRIER TERMINAL STRIP -C -W -50	
GENERAL TOLERANCES (UNLESS SPECIFIED)				EC NO: 793824 DRWN: MADHAM5 CHK'D: GGA APPR: GGA							
4 PLACES ±		±		2024/05/29				PRODUCT CUSTOMER DRAWING		DOCUMENT NUMBER	
3 PLACES ±		± 0.005		2024/08/14				SD-38691-002		PSD 001 A2	
2 PLACES ±		± 0.13 ± 0.01		2024/08/14				MATERIAL NUMBER		CUSTOMER	
1 PLACE ±		±		INITIAL REVISION:				SEE CHART		GENERAL MARKET	
0 PLACES ±		±		DRWN: AHIDALGO APPR: JMACNEIL				SHEET NUMBER		1 OF 1	
ANGULAR TOL ± 2.0 °				THIRD ANGLE PROJECTION		DRAWING		SERIES		SHEET NUMBER	
DRAFT WHERE APPLICABLE MUST REMAIN WITHIN DIMENSIONS				B-SIZE		38691					