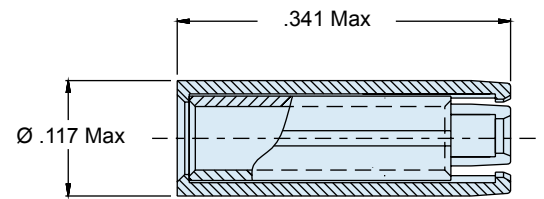
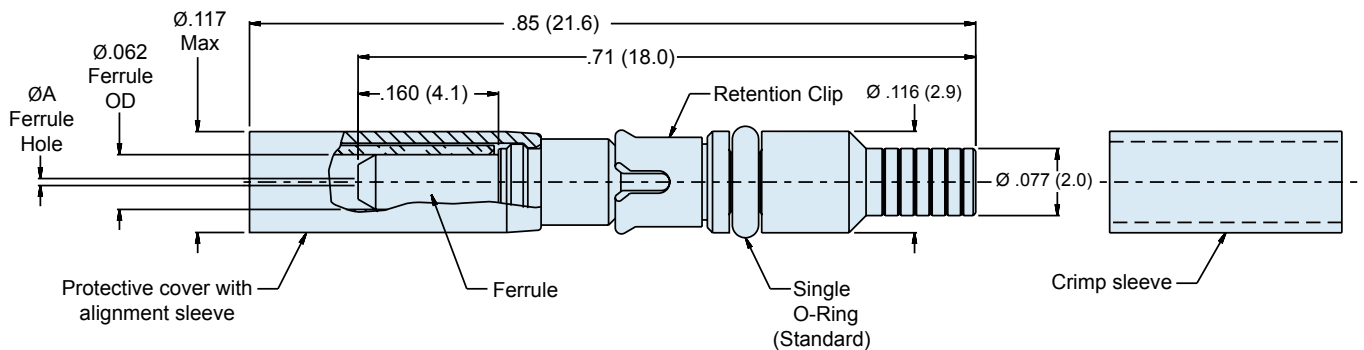

Size 16 COTS Front Release Fiber Optic Socket Terminus

Protective cover with captive alignment sleeve

Material and Finish

Ferrule, Alignment Sleeve: Zirconia Ceramic
 Protective Cover: Spring Alloy
 Terminus Assembly: Stainless Steel/Passivate
 Retention Clip: Spring Alloy
 O-Ring: Fluorosilicone
 Crimp Sleeve: Brass Alloy/Nickel

Tools and Accessories/Assembly Notes

See Glenair GAP-031 and GAP-031B for complete assembly instructions.
 Alignment sleeve assembly (protective cover and alignment sleeve) and crimp sleeve are supplied with assembly. Spares may be ordered separately (See Table II).
 See 181-051 for dummy terminus.

181-011
COTS Fiber Optic Socket Terminus
Size 16 Front Release



Part Number	Fiber Size: Core/Cladding/Coating (Microns)	Ø A (Microns)
181-011-125	9/125 (Single Mode)	125.5
181-011-126S	9/125 (Single Mode)	126.0
181-011-126	50/125, 62.5/125	126.0
181-011-142	100/140	142.0
181-011-156	62.5/125/155 (Polyimide)	156.0
181-011-173	100/140/172 (Polyimide)	173.0
181-011-175	100/140/172 (Polyimide)	175.0
181-011-231	200/225	231.0
181-011-236	200/230	236.0
181-011-286	200/280	286.0
181-011-448	400/440	448.0
<p>Ceramic alignment sleeve supplied with terminus. Add K to the end of part number development to supply with optional stainless steel alignment sleeve e.g. 181-011-126K.</p> <p>For dual O-ring design, add D to end of part number development (e.g. 181-011-126KD)</p>		

Accessories	
Part No.	Terminus Accessories
181-011-S	Protective Cover with Ceramic Alignment Sleeve
181-011-K	Protective Cover with Stainless Steel Alignment Sleeve
265-002	Crimp Sleeve, Ø2.2mm Max Jacket