

## Product Sheet

Part numbers: ASM25PR & ASM32PR



**Temperature range:** -40°C to 100°C, intermittent to approx. 150°C.

**Material:** Polyamide reinforced glass fibre.

**Equipment:** Reducing threaded holes or through holes to smaller thread sizes.

Dimensions in mm

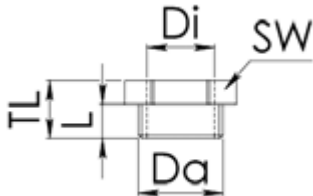

Part no.	Colour	Da	Di	L	SW	TL
ASM25PR	RAL 7035	M25 x 1.5	M20 x 1.5	10	29	17
ASM32PR	RAL 7001	M32 x 1.5	M25 x 1.5	12	36	19