

Panel mounting frames - VS-PPC-F1-RJ45-P0BK-1R-PHA - 1657847

Please be informed that the data shown in this PDF Document is generated from our Online Catalog. Please find the complete data in the user's documentation. Our General Terms of Use for Downloads are valid (<http://phoenixcontact.com/download>)



RJ45 panel mounting frame, IP67, for push-pull interlocking, plastic, for PCB connection, for square panel cutout, with grommet, without mounting screws



Key Commercial Data

Packing unit	1 STK
GTIN	 4 046356 131919
GTIN	4046356131919
Weight per Piece (excluding packing)	5.500 g
Custom tariff number	85366990
Country of origin	Germany
Note	Made to Order (non-returnable)

Technical data

Mechanical characteristics

Insertion/withdrawal cycles	≥ 500
Color	black
Degree of protection	IP65/IP67
Design	RJ45, IP65/67, version 14

Ambient conditions

Ambient temperature (operation)	-40 °C ... 70 °C
---------------------------------	------------------

Material data

Flammability rating according to UL 94	V0
Housing material	PA-GF
Material	Plastic
Sealing material	NBR
Seal material	NBR

Panel mounting frames - VS-PPC-F1-RJ45-P0BK-1R-PHA - 1657847

Technical data

Electrical characteristics

Degree of pollution	2
---------------------	---

Standards and Regulations

Flammability rating according to UL 94	V0
--	----

Environmental Product Compliance

China RoHS	Environmentally friendly use period: unlimited = EFUP-e
	No hazardous substances above threshold values

Drawings

Dimensional drawing

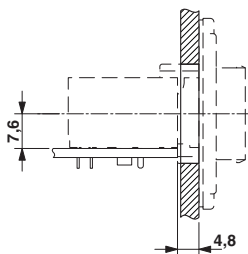

Dimensional drawing

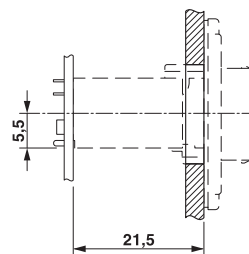

Drilling diagram

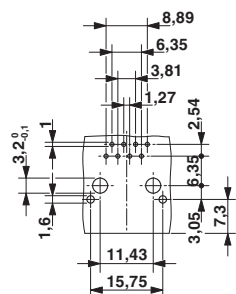

Dimensional drawing

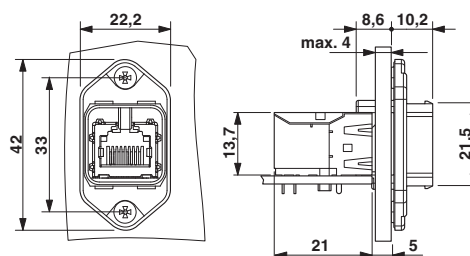

Push-Pull panel mounting frame RJ45

Drilling diagram

Dimensional drawing

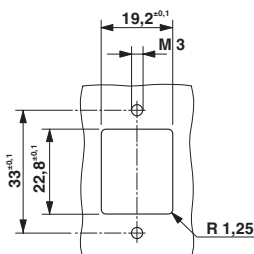

Panel cutout

Panel mounting frames - VS-PPC-F1-RJ45-P0BK-1R-PHA - 1657847

Classifications

eCl@ss

eCl@ss 4.0	272607xx
eCl@ss 4.1	27260701
eCl@ss 5.0	27260701
eCl@ss 5.1	27260701
eCl@ss 6.0	27260708
eCl@ss 7.0	27440312
eCl@ss 8.0	27440210
eCl@ss 9.0	27440210

ETIM

ETIM 3.0	EC001121
ETIM 4.0	EC001121
ETIM 5.0	EC002310
ETIM 6.0	EC002310

UNSPSC

UNSPSC 6.01	31261501
UNSPSC 7.0901	31261501
UNSPSC 11	31261501
UNSPSC 12.01	31261501
UNSPSC 13.2	39121421

Approvals

Approvals

Approvals

EAC

Ex Approvals

Approval details

EAC		B.01742
-----	--	---------

Accessories

Accessories

Female insert

Panel mounting frames - VS-PPC-F1-RJ45-P0BK-1R-PHA - 1657847

Accessories

RJ45 socket insert - VS-08-BU-RJ45-6/LH-1 - 1653087



RJ45 socket insert, for PCB assembly, CAT6, 8-pos., shielded, with angled solder pins, 1x

RJ45 socket insert - VS-08-BU-RJ45-6/LV-1 - 1653090



RJ45 socket insert, for PCB assembly, CAT6, 8-pos., shielded, with straight solder pins, 1x

RJ45 socket insert - CUC-F-J1ZNI-S/R4IDC8 - 1418984



RJ45 socket insert, Degree of protection: IP20, Number of positions: 8, 10 Gbps, CAT6_A, Material: Zinc die-cast, Connection method: IDC connection, Connection cross section: AWG 26-22

RJ45 coupling - CUC-F-D1ZNI-S/R4GC8 - 1419022



RJ45 coupling, Degree of protection: IP20, Number of positions: 8, 1 Gbps, CAT6, Material: Zinc die-cast, Connection method: Female
