

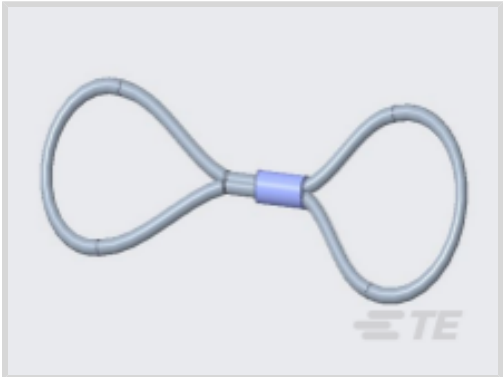

Connectors > Automotive Connectors > Automotive Connector Accessories > Other Automotive Connector Accessories



Automotive Connector Accessory Type: **Cap**

Primary Product Material: **Rubber**

Primary Product Color: **Black**

Operating Temperature Range: **-40 – 108 °C [-40 – 226 °F]**

Features

Product Type Features

Automotive Connector Accessory Type	Cap
-------------------------------------	-----

Body Features

Primary Product Material	Rubber
Primary Product Color	Black

Usage Conditions

Operating Temperature Range	-40 – 108 °C[-40 – 226 °F]
-----------------------------	----------------------------

Product Compliance

[For compliance documentation, visit the product page on TE.com>](#)

EU RoHS Directive 2011/65/EU	Compliant
EU ELV Directive 2000/53/EC	Compliant
China RoHS 2 Directive MIIT Order No 32, 2016	No Restricted Materials Above Threshold
EU REACH Regulation (EC) No. 1907/2006	Current ECHA Candidate List: JUNE 2024 (241) Candidate List Declared Against: JAN 2023 (233) Does not contain REACH SVHC
Halogen Content	Low Halogen - Br, Cl, F, I < 900 ppm per homogenous material. Also BFR/CFR/PVC Free
Solder Process Capability	Not applicable for solder process capability



Product Compliance Disclaimer

This information is provided based on reasonable inquiry of our suppliers and represents our current actual knowledge based on the information they provided. This information is subject to change. The part numbers that TE has identified as EU RoHS compliant have a maximum concentration of 0.1% by weight in homogenous materials for lead, hexavalent chromium, mercury, PBB, PBDE, DBP, BBP, DEHP, DIBP, and 0.01% for cadmium, or qualify for an exemption to these limits as defined in the Annexes of Directive 2011/65/EU (RoHS2). Finished electrical and electronic equipment products will be CE marked as required by Directive 2011/65/EU. Components may not be CE marked. Additionally, the part numbers that TE has identified as EU ELV compliant have a maximum concentration of 0.1% by weight in homogenous materials for lead, hexavalent chromium, and mercury, and 0.01% for cadmium, or qualify for an exemption to these limits as defined in the Annexes of Directive 2000/53/EC (ELV). Regarding the REACH Regulation, the information TE provides on SVHC in articles for this part number is based on the latest European Chemicals Agency (ECHA) 'Guidance on requirements for substances in articles' posted at this URL: <https://echa.europa.eu/guidance-documents/guidance-on-reach>

Compatible Parts

TE Part # CAT-H3910-RC1748

Receptacle Dust Caps — DEUTSCH HD10

TE Part # CAT-H3910-PC1748

DEUTSCH HD10 PLUG DUST CAPS

TE Part # CAT-H396-RC8382

Receptacle Protective Caps — DEUTSCH HDP20

Customers Also Bought

TE Part #1011-250-1205

DEUTSCH DT Backshells

TE Part #HDC26-18

DUST CAP, 18SZ, REC, BLK, HDP

TE Part #HDC16-9-E004

DUST CAP ASM

TE Part #DT04-3P-CE09

REC, 3P, BLK, E, XCAP

TE Part #3-2112162-1

21POS,TAB2.8X0.8,TABHSG,CODE C, ASSY,SLD

TE Part #DRC18-40SBE-P013

PLG, 40P, BLK, E, SEAL BOND, B

TE Part #DT06-2S-LC01

PLG, 2P, BLK, E, SL RT, DIN BKSHL ADPT

TE Part #4828-007-8605

BKSHL, 86P, BLK, VERTICAL, DRCP



Documents

Product Drawings

RUBBER LANYARD

English

CAD Files

3D PDF

3D

Customer View Model

ENG_CVM_CVM_JDL082397_99.2d_dxf.zip

English

Customer View Model

ENG_CVM_CVM_JDL082397_99.3d_igs.zip

English

Customer View Model

ENG_CVM_CVM_JDL082397_99.3d_stp.zip

English

By downloading the CAD file I accept and agree to the [Terms and Conditions](#) of use.

Datasheets & Catalog Pages

CONNECTOR SELECTOR

English

Product Specifications

Application Specification

English