

SAMZO REAC/ROHS

| REV | ECN NO | DESCRIPTION | DESIGN | APPROVAL | DATE |
|-----|--------|---------------|--------|----------|------------|
| A1 | NEW | Replace frame | | | 2013.06.21 |
| | | | | | |

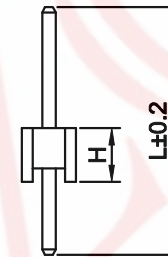
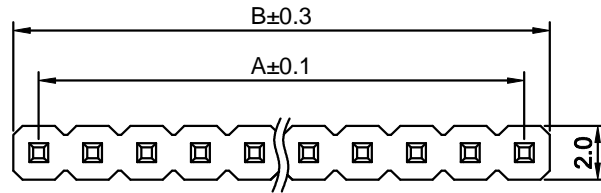

| Options | PA | PC | H | L |
|-----------|-----|-----|-----|-----|
| Standard | 4.0 | 2.8 | 2.0 | 8.8 |
| Specified | | | | |

SPECIFICATIONS

Current Rating: 1.5 Amps
 Insulation Resistance: 1000M Ω M in
 Contact Resistance: 20m Ω Max W
 Withstanding Voltage: AC 500V
 Operation Temperature: -40°to+105°

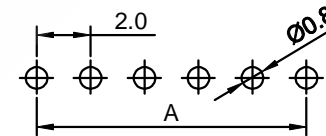
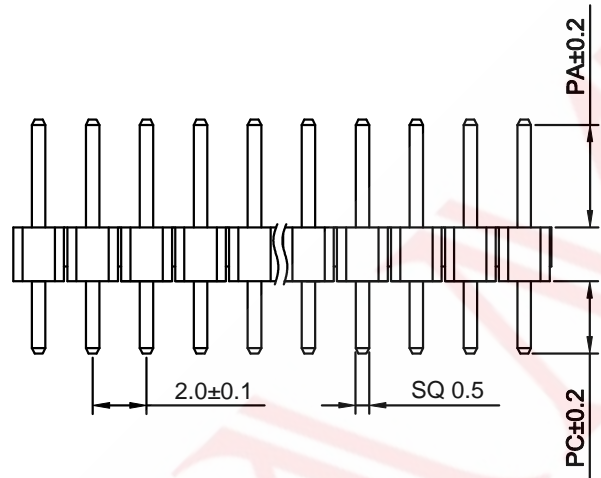

RECOMMEND P. C. B LAYOUT
 PCB TOLERANCE: ±0.05 (TOP VIEW)

| No. of Contacts | DIMENSIONS | | No. of Contacts | DIMENSIONS | |
|-----------------|------------|-------|-----------------|------------|-------|
| | A | B | | A | B |
| 1 | 0.00 | 2.00 | 21 | 40.00 | 42.00 |
| 2 | 2.00 | 4.00 | 22 | 42.00 | 44.00 |
| 3 | 4.00 | 6.00 | 23 | 44.00 | 46.00 |
| 4 | 6.00 | 8.00 | 24 | 46.00 | 48.00 |
| 5 | 8.00 | 10.00 | 25 | 48.00 | 50.00 |
| 6 | 10.00 | 12.00 | 26 | 50.00 | 52.00 |
| 7 | 12.00 | 14.00 | 27 | 52.00 | 54.00 |
| 8 | 14.00 | 16.00 | 28 | 54.00 | 56.00 |
| 9 | 16.00 | 18.00 | 29 | 56.00 | 58.00 |
| 10 | 18.00 | 20.00 | 30 | 58.00 | 60.00 |
| 11 | 20.00 | 22.00 | 31 | 60.00 | 62.00 |
| 12 | 22.00 | 24.00 | 32 | 62.00 | 64.00 |
| 13 | 24.00 | 26.00 | 33 | 64.00 | 66.00 |
| 14 | 26.00 | 28.00 | 34 | 66.00 | 68.00 |
| 15 | 28.00 | 30.00 | 35 | 68.00 | 70.00 |
| 16 | 30.00 | 32.00 | 36 | 70.00 | 72.00 |
| 17 | 32.00 | 34.00 | 37 | 72.00 | 74.00 |
| 18 | 34.00 | 36.00 | 38 | 74.00 | 76.00 |
| 19 | 36.00 | 38.00 | 39 | 76.00 | 78.00 |
| 20 | 38.00 | 40.00 | 40 | 78.00 | 80.00 |

- A. 名称: 5A-排针
- B. 间距: K-2.0mm
- C. 方式: L-180° DIP
- D. 塑高(H): 3-2.0mm
- E. 总长(L): 88-8.8mm
- F. 上针长(PA): 40-4.0
- G. 针数: 102-1*2P(2-40PIN)
- H. 定位: W-无定位
- I. 物料编码: 0-常规

5A K L 3 - 88 40 - 1** - W 0
 A B C D E F G H I

| ITEM | DESCRIPTION | MATERIAL | QTY | FINISH/COLOR | | | | |
|------|-------------|----------|-----|--------------|----------|-------------|-------------------|-------------|
| 1 | 针 | 黄铜 | N | 镀金 | | | | |
| 2 | 主体 | PA6T | 1 | 黑色 | | | GENERAL TOLERANCE | |
| | | | | | DESIGN | WANGGUIFA | 2018.06.12 | ≥0~2< ±0.15 |
| | | | | | CHECKED | ZHENGUILAN | 2018.06.12 | ≥2~5< ±0.25 |
| | | | | | APPROVED | LILIANJIANG | 2018.06.14 | ≥0~2< ±0.15 |
| | | | | | | | | ≥5 ±0.35 |

FIRST VIEW

SCALE 1:1 UNIT mm

SAMZO COMPONENTS
 Electronic switch and connector manufacturer

The copyright belongs to samzo parts [China] Co., Ltd. please use the material after samzo parts agree to authorize. The final right of interpretation belongs to samzo parts.
 WWW.KKK-JP.COM

TITLE: 2.0PH 1*NP H2.0 L8.8 180°

DWG NO: 5AKL3-P20001

PART NO: 5AKL321031707

MODEL NO: 5AKL3-8840-1NP-W0

NAME: PIN-H CONNECTOR