

# PART NUMBERING CONSTRUCTION

## EM7127XX

NO. OF POLES (PER ROW)  
2 THRU 16

PART NO.  
EM7127XX-SALES

PLANT DISTRIBUTION CODE  
56 U

### SPECIFICATIONS:

RATING: 15A, 300V  
 CENTER SPACING: 3.81/[.150]  
 WIRE SIZE: #16-22AWG  
 HOUSING MATERIAL: P.B.T.(UL94V-0)  
 CONTACT MATERIAL: BRASS, TIN PLATED  
 SCREW SIZE: M 3X0 NICKEL PLATED STEEL  
 RECOMMENDED PCB HOLE DIAMETERS: 1.33/[.052]  
 AGENCY APPROVALS: PENDING

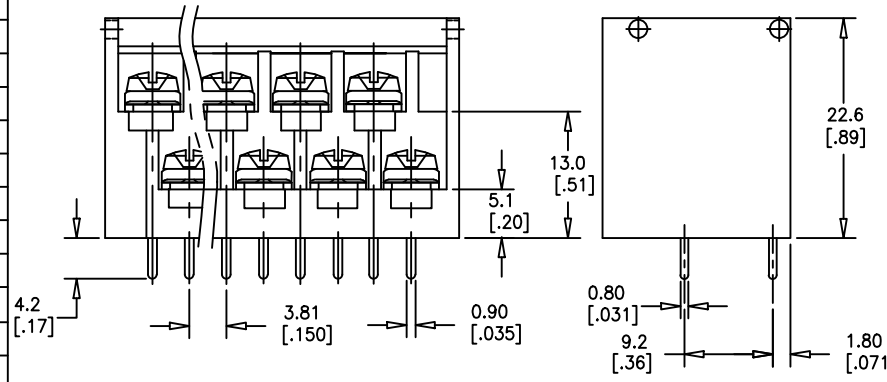
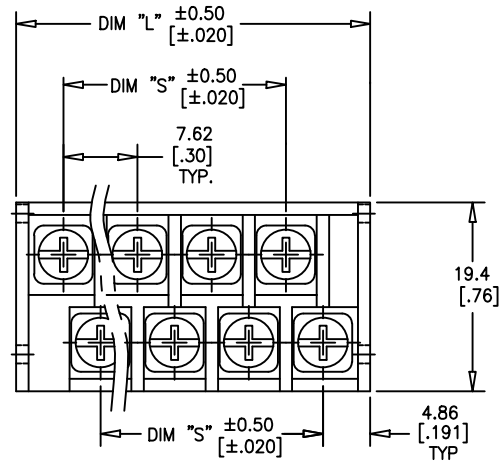

PART NO.	# POS.	DIM. "L"	DIM. "S"
EM712703	3	28.8/[1.13]	15.2/[.59]
EM712704	4	36.4/[1.43]	22.9/[.90]
EM712705	5	44.0/[1.73]	30.5/[1.20]
EM712706	6	51.6/[2.03]	38.1/[1.50]
EM712708	8	66.9/[2.63]	53.3/[2.10]
EM712709	9	74.5/[2.93]	61.0/[2.40]
EM712710	10	82.1/[3.23]	68.6/[2.70]
EM712711	11	89.7/[3.53]	76.2/[3.00]
EM712712	12	97.4/[3.83]	83.8/[3.30]
EM712713	13	105.0/[4.13]	91.4/[3.60]
EM712714	14	112.6/[4.43]	99.1/[3.90]
EM712715	15	120.2/[4.73]	106.7/[4.20]
EM712716	16	127.8/[5.03]	114.3/[4.50]

TOLERANCES UNLESS OTHERWISE SPECIFIED			THIRD ANGLE PROJECTION	DESIGN UNITS
METRIC	ENGLISH	FRACTIONAL TOL		Metric/English
1 PL DEC.=±0.25	2 PL DEC.=±0.01	ANGULAR TOL= ±1°		CREATED USING
2 PL DEC.=±0.13	3 PL DEC.=±0.005	ANGULAR TOL 1PL=±0.5°		AUTOCAD

**COPYRIGHT** — Cooper Industries, Inc.  
 This is an unpublished work. The disclosure of this work is limited to a select personnel. Further dissemination or disclosure to the public is PROHIBITED. This unpublished work is protected by Federal Copyright Law and all rights thereunder are reserved by Cooper Industries, Inc.

**CONFIDENTIAL** —  
 The information contained in this document is the property of Cooper Industries, Inc. It is not for public disclosure. Possession of the information does not convey any right to loan, sell or disclose the information. Unauthorized reproduction or use of the information is PROHIBITED. This document is to be returned to Cooper Industries, Inc. upon completion of the purpose for which it is loaned or upon request.

MATERIAL		DRAWN BY	
FINISH		RF	
		DATE	11/20/98
		C/F NO.	70710
		SCALE	2:1

TITLE  
 .300" CNETERS DUAL LEVEL PCB BARRIER TERMINAL BLOCKS WITH COVER

PART NO.  
 EM7127XX-SALES

SIZE:  
 SHT 1 OF 1 B

REV: 10/00

# Mouser Electronics

Authorized Distributor

Click to View Pricing, Inventory, Delivery & Lifecycle Information:

[Eaton:](#)

[EM712705](#) [EM712710](#) [EM712703](#) [EM712709](#) [EM712707](#) [EM712702](#) [EM712711](#) [EM712712](#) [EM712704](#)  
[EM712706](#) [EM712713](#) [EM712708](#)