

Recommended PCB Layout (Bottom View)

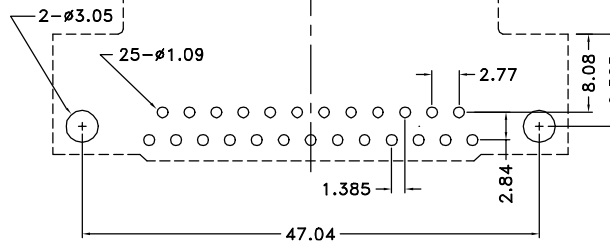

Material and Finish

Shell: Steel, zinc plated or tin plated

Insulator: PBT with glass-fiber reinforcement
UL 94V-0
color-black

Contact Material:
Phosphor Bronze

Duplex plated as follows:

- 30 .000030" [0.00076mm] gold on mating end, tin-lead on termination end, with entire contact nickel
- 15 .000015" [0.00038mm] gold on mating end, tin-lead on termination end, with entire contact nickel

(Standard) Gold flash on mating end, Gold flash or tin-lead on termination end, with nickel underplate on entire contact

Electrical Specifications

Rated Current:

5A

Rated Voltage:
300V DC

Withstanding Voltage:
500V (rms) AC for 1 min

Insulation Resistance:
more than 1000 Mohm at 500v DC

Contact Resistance:
13 mohm Max

Dielectric Strength:
1000V for 1 min

Temperature Rating:
-55°C to +105°C

Ferrite Specifications		
Test Frequency	Edge Hole	Inner Hole
30 Mhz	17-27 Ohms	22-30 Ohms
50 Mhz	22-30 Ohms	29-37 Ohms
100 Mhz	29-34 Ohms	35-40 Ohms

Part Number	t_gold
KF22-B25S-N	Flash
KF22-B25S-N15	15u"
KF22-B25S-N30	30u"

CSA NRTL/C Certified File No. LR78160
UL Recognized File No. E169636

REVISION	DATE	DESCRIPTION	DRAWN BY	DESIGNED BY	UNITS
A	2/12/98	New Drawing	C. Leiva		mm
A2	10/26/00	Ref ECD 00-122	CHECKED BY	APPROVED BY	DATE
					2/12/98

KF22-B25S-N

Rt. Ang Ferrite D-Sub

25 Pos. Female, 0.318" Footprint



Mouser Electronics

Authorized Distributor

Click to View Pricing, Inventory, Delivery & Lifecycle Information:

[Kycon:](#)

[KF22-B25S-N](#)