

| | |
|--|-------|
| TOLERANCE UNLESS OTHERWISE SPECIFIED | |
| .X | ±0.15 |
| .XX | ±0.10 |

THIS IS A C.A.D. GENERATED DRAWING
DO NOT MAKE MANUAL REVISIONS TO MASTER.

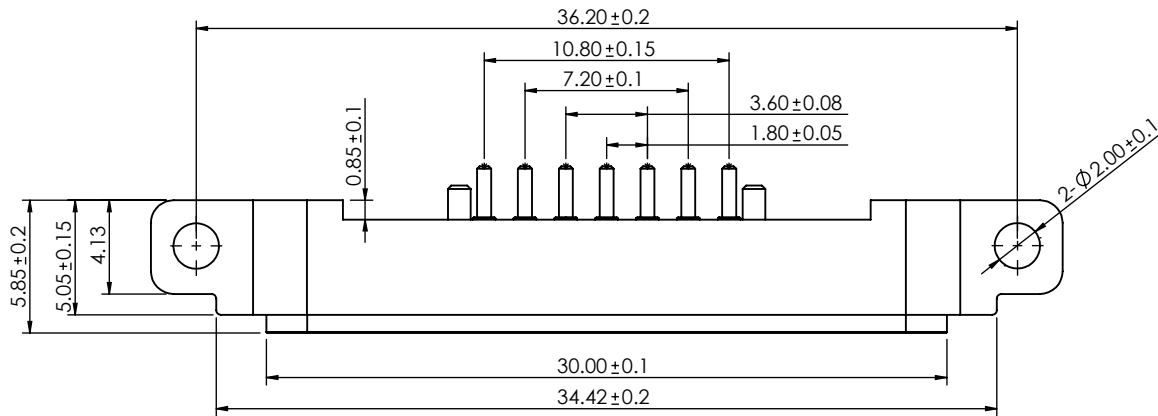

| | |
|----------------|----------------|
| ISSUE NUMBER | |
| ORIGINAL | ① |
| ADD NOTE 5 & 6 | |
| P.M. | AUG. 13/2023 ② |



SPECIFICATION:

- MATERIAL:
CONTACT: BRASS, GOLD FLASH PLATING ALL OVER NICKEL UNDERPLATING
HOUSING: PA46, BLACK
MAGNET: N52
- ELECTRICAL CHARACTERISTICS:
RATED VOLTAGE (PER CONTACT): 12V
RATED CURRENT (PER CONTACT): 2A
INSULATION RESISTANCE: 100MEGAOHMS MIN.
DIELECTRIC WITHSTANDING VOLTAGE: 100V AT 60Hz
CONTACT RESISTANCE: 30mOHMS MAX. BEFORE TEST AND 60mOHMS MAX. AFTER TEST
- SALT SPRAY TEST: 5% SALT SPRAY CONCENTRATION, TEMPERATURE 35°C,
TEST TIME 24 HOURS, NO CORROSION
- WORKING TEMPERATURE RANGE: -30~+85°C.
- RECOMMENDED SOLDERING PROCESS ARE SELECTIVE SOLDERING OR MANUAL SOLDERING. OTHER FORMS OF SOLDERING SUCH AS WAVE SOLDER OR REFLOW SOLDER ARE NOT RECOMMENDED AND CAN POTENTIALLY CAUSE DEMAGNETIZATION OF MAGNET IN THE CONNECTOR
- MATING WITH: 687B14224611100 OR 685B1422261115E

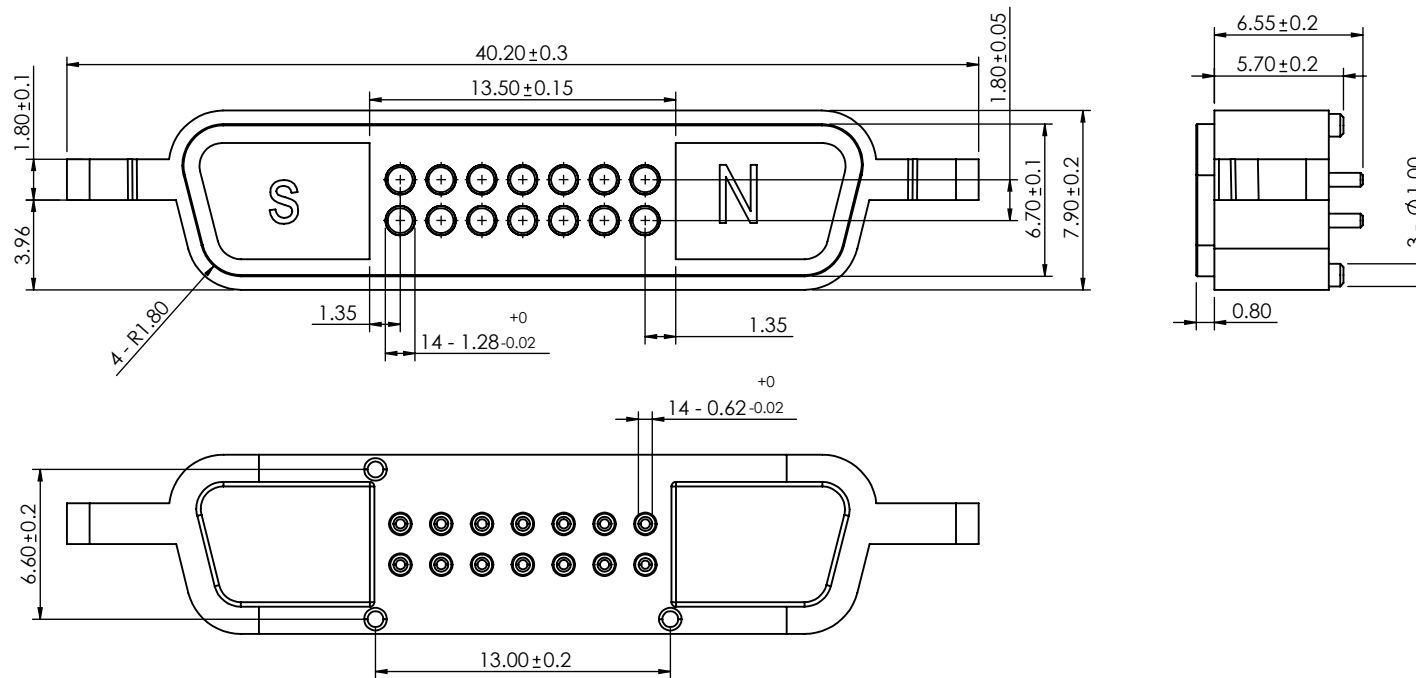

MAGNETIC SPRING LOADED CONNECTOR,
14POS, FEMALE

| | | |
|---------------------|-----------------|-----------------|
| ACAD REFERENCE NO.: | 686B1421260123E | UNIT: MM |
| DRAWN: | J.L. | DATE: 8/13/2023 |
| CHECKED: | R.S.M | DATE: 8/13/2023 |
| SCALE: | (IN CAD 1:1) | SHEET 1 OF 1 |
| DRAWING NUMBER: | 686B1421260123E | ISSUE |
| PART NUMBER: | 686B1421260123E | 2 |



THIS SERIES FULLY CONFORMS TO
THE EUROPEAN UNION DIRECTIVES
2011/65/EU FOR RoHS COMPLIANCY.



YOUR CONNECTION TO QUALITY & SERVICE

EDAC INC
TORONTO, ONTARIO
CANADA

THESE DRAWINGS AND SPECIFICATIONS
ARE THE PROPERTY OF EDAC INC., AND
SHALL NOT BE REPRODUCED, OR COPIED
OR USED AS THE BASIS FOR THE
MANUFACTURE OR SALE OF APPARATUS
WITHOUT WRITTEN PERMISSION.