

DATASHEET

ITEM: 35081X

**WHEEL AS 200X50/60 INOX ROLLER
BEARING 20**

WHEEL SERIE

Wheels with cast soft polyurethane coating 87 Sh.A
on polyamide 6 center.

Wheel fitted with stainless steel roller bearing.

TECHNICAL DETAILS

Wheel diameter	(D)	200 mm
Tyre width	(E)	50 mm
Bore diameter	(d)	20 mm
Reference weight		1,100 kg
Hub width	(L)	60 mm
Load capacity		600 kg

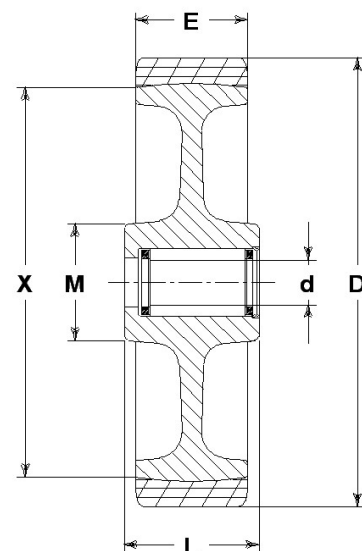

GENERAL INFORMATION / RECOMMENDATIONS AND WARNINGS

The cited text and the complete catalogue in their most up-dated versions are available in our web-site www.lagspa.eu/web/downloads. The dimensions, descriptions, specifications and illustrations herein are indicative and subject to variations without notice. The fact that products are illustrated herein does not necessarily imply they are available from stock nor does it place us under any obligation to supply them. Tests carried out refer to the original products with original accessories: the replacement of one of the components with others of different manufacture might prevent the same results from being achieved and will automatically invalidate any guarantee. Please contact our technical service concerning any special application.