

标记 MARK	ECN编号/变更内容 ECN NO/DEFINITION					修改 REVISE	日期 DATE			核准 APPROVE		
PIN	DIM A	DIM B	PIN	DIM A	DIM B	PIN	DIM A	DIM B	PIN	DIM A	DIM B	
1	—	2.54	11	25.40	27.94	21	50.80	53.34	31	76.20	78.74	
2	2.54	5.08	12	27.94	30.48	22	53.34	55.88	32	78.74	81.28	
3	5.08	7.62	13	30.48	33.02	23	55.88	58.42	33	81.28	83.82	
4	7.62	10.16	14	33.02	35.56	24	58.42	60.96	34	83.82	86.36	
5	10.16	12.70	15	35.56	38.10	25	60.96	63.50	35	86.36	88.90	
6	12.70	15.24	16	38.10	40.64	26	63.50	66.04	36	88.90	91.44	
7	15.24	17.78	17	40.64	43.18	27	66.04	68.58	37	91.44	93.98	
8	17.78	20.32	18	43.18	45.72	28	68.58	71.12	38	93.98	96.52	
9	20.32	22.86	19	45.72	48.26	29	71.12	73.66	39	96.52	99.06	
10	22.86	25.40	20	48.26	50.80	30	73.66	76.20	40	99.06	101.60	

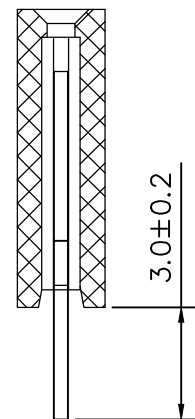

**SPECIFICATIONS**  
 Current Rating: 3 Amps  
 Withstanding Voltage: AC 1000V  
 Insulation Resistance: 1000MΩ Min  
 Contact Resistance: 20mΩ Max  
 Operation Temperature: -40°to+105°  
 Insrlator Material: Polyester  
 Contact Material: Brass  
 Standard: PA6T  
 Contact Plating: Gold Flash  
 Max.Processing Temp: 200°C for 30-60seconds  
 (255°C for 5seconds)

H	PC	PB
8.5	3.0	

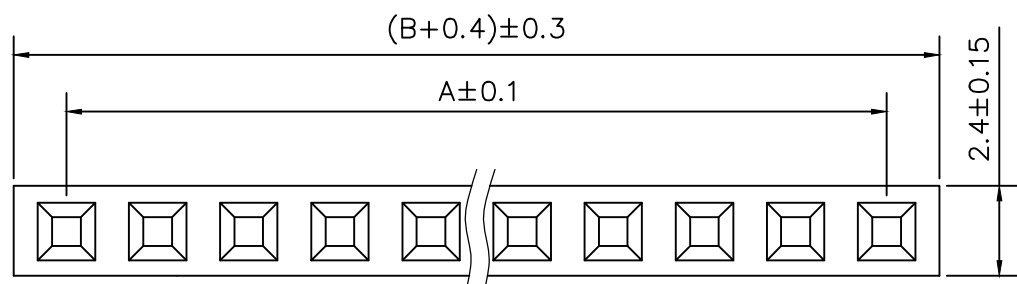
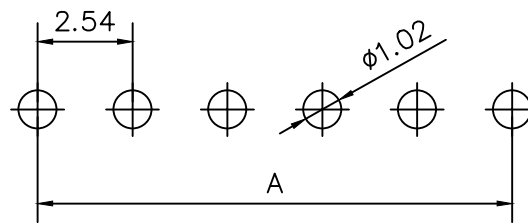
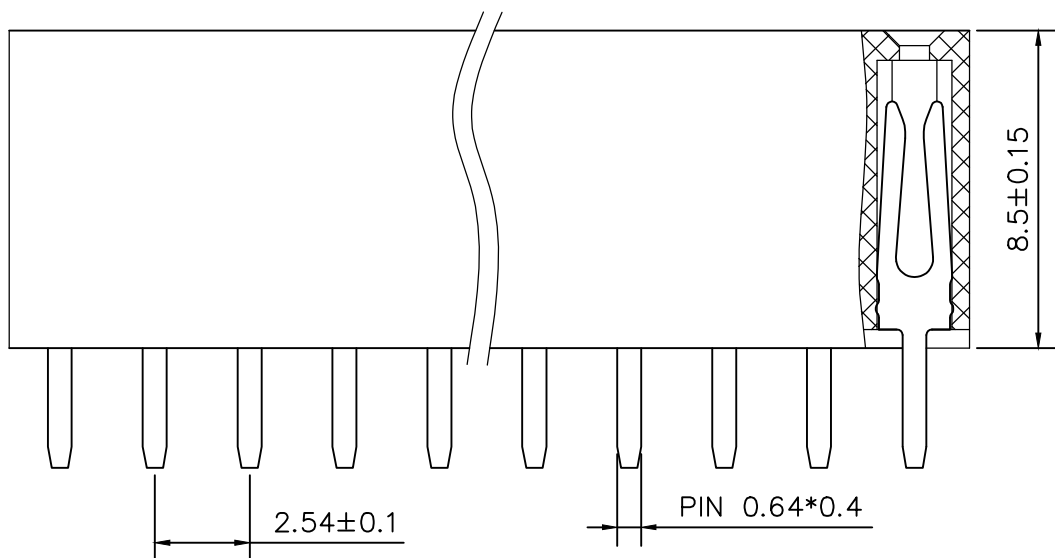

RECOMMEND P. C. B LAYOUT  
 PCB TOLERANCE: ±0.05 (TOP VIEW)

2	接触	铜	镀金	
1	基座	PA6T	本色	
序号	品名	材质	电镀/颜色	备注

	深圳市虹成电子有限公司			品名 TITLE	排母
				料号 PART NO	HC-PM254-8.5H-1x7PZ
一般公差 TOLERANCE		比列 SCALE	1:1		
X : ±0.30	X° : ±5°	单位 UNIT	MM		
X.X : ±0.25	X.X° : ±1°	张数 PART NO	1 OF 1		
X.XX : ±0.20	X.XX° : ±0.5°	版本 REV	A	制图 DRAW	AhYe
			审核 CHECKED	夏操云	
			批准 APPROVE	赵亮亮	