

Terminal blocks

D - Power terminal blocks



Summary

1. Terminal blocks DIN 3 with bistable foot and base mounting

Terminal blocks with 2 studs	298
Terminal blocks with 1 stud and 1 wire clamp	301

2. Power terminal blocks type I

Terminal blocks with 1 stud	304
Terminal blocks with 2 studs	305
Terminal blocks with 1 stud and 1 wire clamp	307

3. Power terminal blocks type II

Terminal blocks with 1 stud and 2 screws for lug	310
--	-----



POWER TERMINAL BLOCKS

TECHNICAL SPECIFICATIONS

Marking

Many marking possibilities :
RC, RPC and wire marker

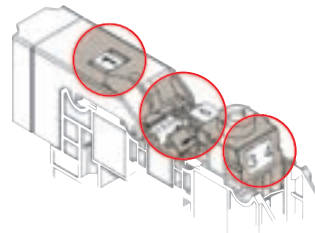

Covers

- Enhanced covers resistance triple hook system
- Cover can be cut to reduce space or for flexible bar connection



Versions

- AF version (Screw clamp / Stud)
easy connection to the field

- FF version (2 Studs with cover)



- FF version (2 Studs without cover)

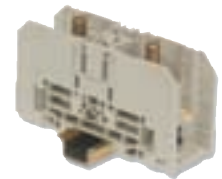

Locking

Assembly solutions

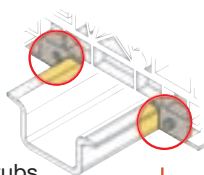

With stubs

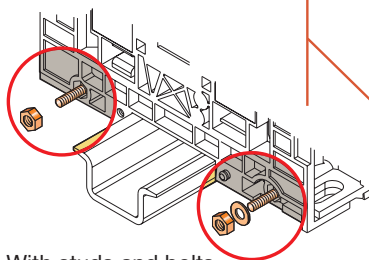

With studs and bolts

Jumper bar

- Pivoting marker holder, Jumpers remain IP20
- Move the marker holders up
- Cut out the partition
- Screw the jumper bar

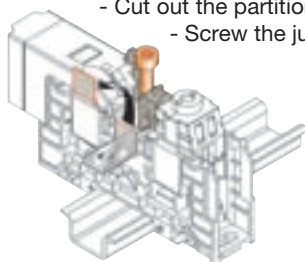

Locking foot

Can be opened from the center or the sides

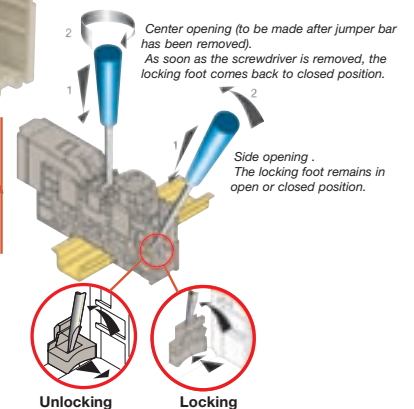
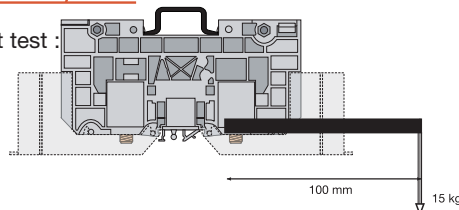

Plate mounting housing

Rail mounting foot test :
High resistance



STUD / SCREW CLAMP : SAME SAFETY FEATURES

Stud connection

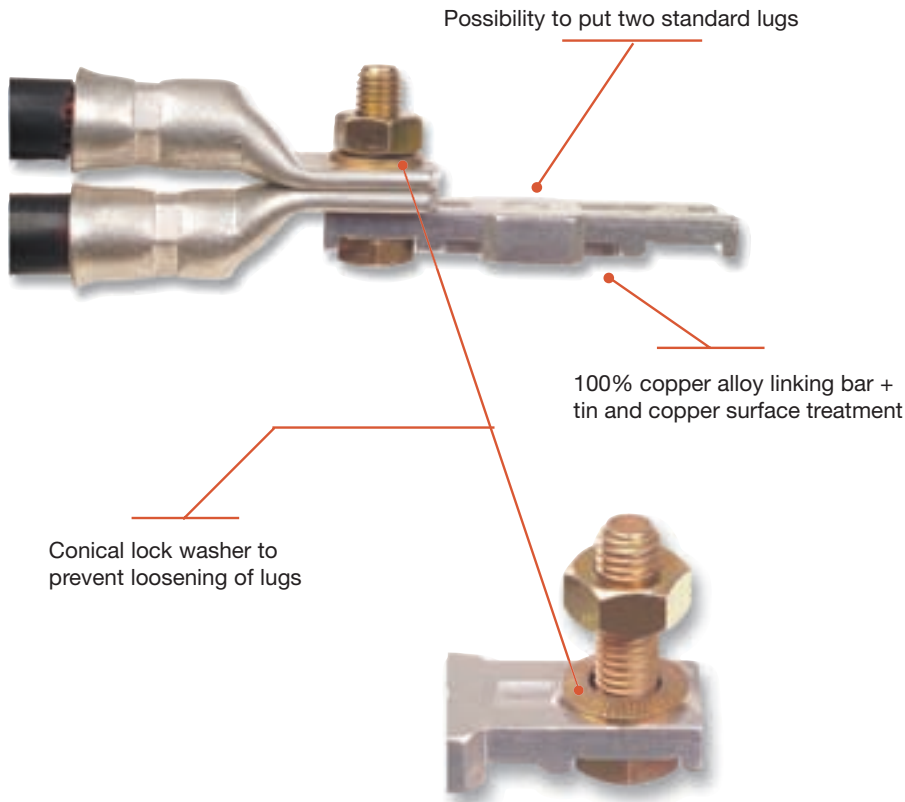

Screw clamp connection

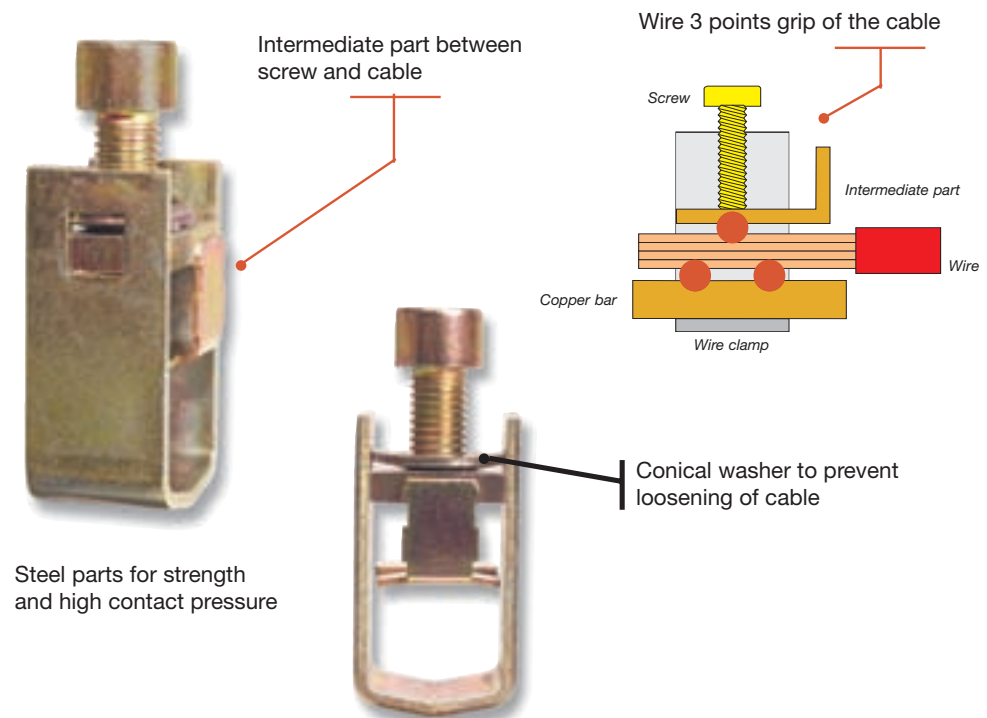

Power terminal blocks

DIN 3 with bistable foot and base mounting

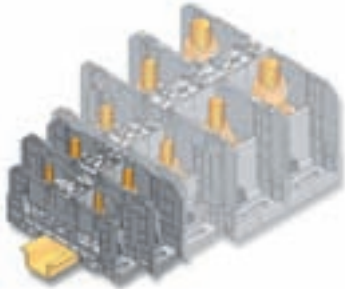

refer to the section "Special Applications" for part numbers and characteristics.

Rail		35 x 7,5 x 1	PR3.Z2	1SNA 174 300 R1700
Rail		35 x 15 x 2,3	PR4	1SNA 168 500 R1200
Rail		35 x 15 x 1,5	PR5	1SNA 168 700 R2200
Other rails : see section on accessories.				

Notes

1

* NFC 20130
 ** DIN 46234
 Base mounting with M6 screws.
 See drilling next page.

Accessories

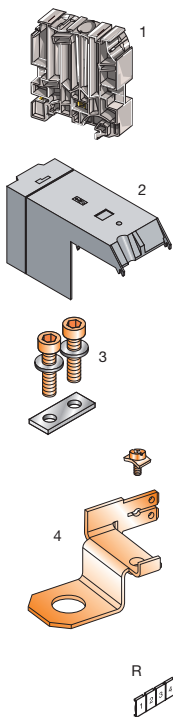

- 1 End stop (other end stops : see accessories)
- 2 Rotating protective cover IP 20
- 3 Jumper bar with CHc screws
2 poles
3 poles
- 4 TAP for Faston 6.35 x 0.8 mm and screw

R See marking chapter
 Marking method

D 35/27.FF

Spacing 27 mm (1.06")

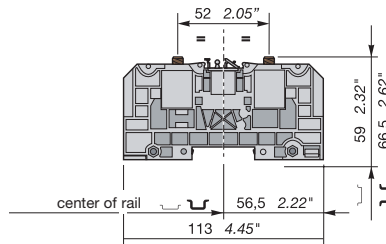

2 studs M6



Color	Type	Part number
Grey V0 without cover	D35/27.FF	1SNA 190 001 R2000
Grey V0 delivered with two covers	D35/27.FF	1SNA 190 033 R1700

D 70/32.FF

Spacing 32 mm (1.26")

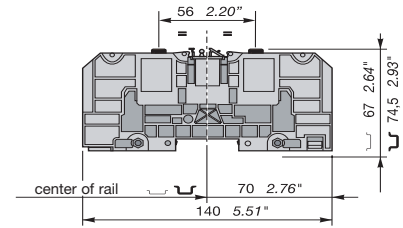

2 studs M8

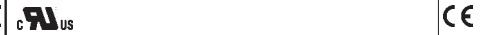

Color	Type	Part number
Grey V0 without cover	D70/32.FF	1SNA 190 002 R2100
Grey V0 delivered with two covers	D70/32.FF	1SNA 190 034 R1000

Characteristics

Wire size	IEC		UL/CSA
	NFC*	DIN**	
Lug Rigid	2,5-35 mm ²	2,5-50 mm ²	1 AWG max.
C4* Flexible	2,5-35 mm ²	2,5-35 mm ²	1 AWG max.

Rated voltage		
V =~	1000	600
Impulse withstand	8 kV	
Pollution degree	3	

Rated current		
Nominal	125 A	125 A

Rated wire size			
Nominal	35 mm ²		1 AWG max.
Lug	Central screw	Wire-clamp	Wire stripping length

Recommended wrench	H 10 mm	6 mm Allen key
Recommended torque	3-6 Nm/26.1-52 lb.in	6-12 Nm/52-104 lb.in

Characteristics

Wire size	IEC		UL/CSA
	NFC*	DIN**	
Lug Rigid	6-95 mm ²	6-70 mm ²	000 AWG max.
C6* Flexible	6-70 mm ²	6-70 mm ²	000 AWG max.

Rated voltage		
V =~	1000	600
Impulse withstand	8 kV	
Pollution degree	3	

Rated current		
Nominal	192 A	170 A

Rated wire size			
Nominal	70 mm ²		000 AWG max.
Lug	Central screw	Wire-clamp	Wire stripping length

Recommended wrench	H 13 mm	6 mm Allen key
Recommended torque	6-12 Nm/52-104 lb.in	6-12 Nm/52-104 lb.in

Type		Part number
BADH		th. 12 mm 1SNA 116 900 R2700
CPUF35	V0 grey	1SNA 190 016 R1600
BJS27		1SNA 205 772 R1300
BJS27		1SNA 205 773 R1400
DRF6		1SNA 205 767 R1600
On cover :	On the middle :	
RC810	RC810 or RPC	

Type		Part number
BADH		th. 12 mm 1SNA 116 900 R2700
CPUF70	V0 grey	1SNA 190 017 R1700
BJS32		1SNA 205 774 R1500
BJS32		1SNA 205 775 R1600
DRF8		1SNA 205 768 R2700
On cover :	On the middle :	
RC810	RC810 or RPC	

Power terminal blocks

DIN3 with bistable foot and base mounting

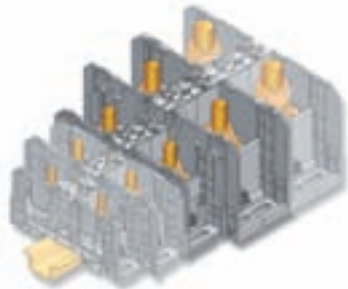

refer to the section "Special Applications" for part numbers and characteristics.

Rail		35 x 7,5 x 1	PR3.Z2	1SNA 174 300 R1700
Rail		35 x 15 x 2,3	PR4	1SNA 168 500 R1200
Rail		35 x 15 x 1,5	PR5	1SNA 168 700 R2200
Other rails : see section on accessories.				

Notes

* NFC 20130
 ** DIN 46234
 Base mounting with M6 screws.
 See drilling next page.

Recommended wrench	H 17 mm	6 mm Allen key
Recommended torque	10-20 Nm/87-174 lb.in	6-12 Nm/52-104 lb.in

Accessories

	1 End stop (other end stops : see accessories)
	2 Rotating protective cover IP 20
	3 Jumper bar with ChC screws 2 poles 3 poles
	4 TAP for Faston 6.35 x 0.8 mm and screw
	R See marking chapter Marking method

D 120/42.FF

Spacing 42 mm (1.65")

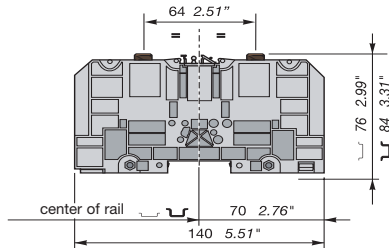

2 studs M10

--	--

Color	Type	Part number	Color	Type	Part number
Grey V0	<input type="checkbox"/>	D120/42.FF 1SNA 190 003 R2200			
without cover					
Grey V0	<input type="checkbox"/>	D120/42.FF 1SNA 190 035 R1100			
delivered with two covers					

Characteristics

Wire size	Lug	Rigid	IEC		UL/CSA
			NFC*	DIN**	
C8*	Flexible		6-150 mm ²	6-120 mm ²	300 MCM max.
			6-120 mm ²		300 MCM max.

Characteristics

Wire size	Lug	Rigid	IEC		UL/CSA
			NFC*	DIN**	
C8*	Flexible				

Rated voltage

V =~	1000	600
Impulse withstand	8 kV	
Pollution degree	3	

Rated voltage

V =~		
Impulse withstand		
Pollution degree		

Rated current

Nominal	269 A	269 A
---------	-------	-------

Rated current

Nominal		
---------	--	--

Rated wire size

Nominal	120 mm ²	300 MCM max.
---------	---------------------	--------------

Rated wire size

Nominal		
---------	--	--

	Lug	Central screw	Wire-clamp	Wire stripping length
	H 17 mm	6 mm Allen key		

	Lug	Central screw	Wire-clamp	Wire stripping length

Type	Part number	Type	Part number
BADH	th. 12 mm 1SNA 116 900 R2700		
CPUF120	V0 grey 1SNA 190 018 R2000		
BJS42	1SNA 205 776 R1700		
BJS42	1SNA 205 777 R1000		
DRF10	1SNA 205 769 R2000		
On cover :	RC 810	On the middle :	RC 810 or RPC

Power terminal blocks

DIN 3 with bistable foot and base mounting

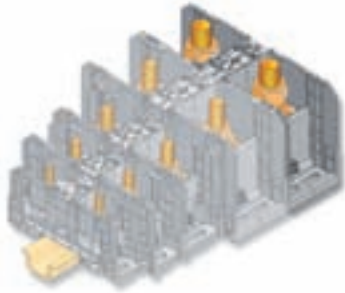

refer to the section "Special Applications" for part numbers and characteristics.

Rail	35 x 7,5 x 1	PR3.Z2	1SNA 174 300 R1700
Rail	35 x 15 x 2,3	PR4	1SNA 168 500 R1200
Rail	35 x 15 x 1,5	PR5	1SNA 168 700 R2200
Other rails : see section on accessories.			

Notes

- * NFC 20130
- ** DIN 46234
- Base mounting with M6 screws.
- See drilling next page.

Accessories

- End stop (other end stops : see accessories)
- Rotating protective cover IP 20
- Jumper bar with ChC screws
2 poles
3 poles
- TAP for Faston 6.35 x 0.8 mm and screw

R See marking chapter
Marking method

D 185/55.FF

Spacing 55 mm (2.16")

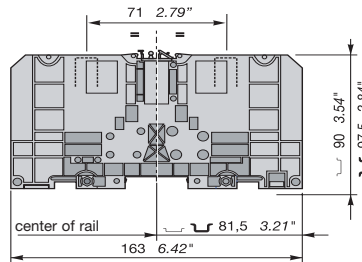

2 studs M12



Color	Type	Part number
Grey V0 without cover	D185/55.FF	1SNA 190 004 R2300
Grey V0 delivered with two covers	D185/55.FF	1SNA 190 036 R1200

D 300/55.FF

Spacing 55 mm (2.16")

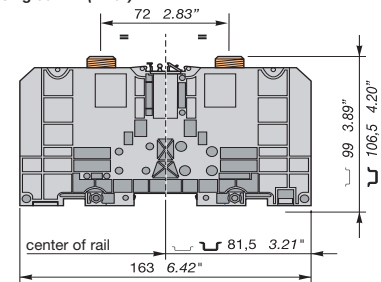

2 studs M16



Color	Type	Part number
Grey V0 without cover	D300/55.FF	1SNA 190 005 R2400
Grey V0 delivered with two covers	D300/55.FF	1SNA 190 037 R1300

Characteristics

Wire size	IEC		UL/CSA
	NFC*	DIN**	
Lug Rigid	25-240 mm ²	6-185 mm ²	500 MCM max.
C11* Flexible	6-185 mm ²		500 MCM max.

Rated voltage		
V =~	1000	600
Impulse withstand	8 kV	
Pollution degree	3	

Rated current		
Nominal	353 A	353 A

Rated wire size			
Nominal	185 mm ²		500 MCM max.
Lug	Central screw	Wire-clamp	Wire stripping length

Recommended wrench	H 19 mm	6 mm Allen key
Recommended torque	14-30 Nm/121-267 lb.in	6-12 Nm/52-104 lb.in

Characteristics

Wire size	IEC		UL/CSA
	NFC*	DIN**	
Lug Rigid	25-300 mm ²	6-300 mm ²	1000 MCM max.
Flexible	6-300 mm ²		1000 MCM max.

Rated voltage		
V =~	1000	600
Impulse withstand	8 kV	
Pollution degree	3	

Rated current		
Nominal	520 A	460 A

Rated wire size			
Nominal	300 mm ²		1000 MCM max.
Lug	Central screw	Wire-clamp	Wire stripping length

Recommended wrench	H 24 mm	6 mm Allen key
Recommended torque	25-50 Nm/217-435 lb.in	6-12 Nm/52-104 lb.in

Type	Part number	Type	Part number
BADH	th. 12 mm 1SNA 116 900 R2700	BADH	th. 12 mm 1SNA 116 900 R2700
CPUF185	V0 grey 1SNA 190 019 R2100	CPUF185	V0 grey 1SNA 190 019 R2100
BJS551	1SNA 205 778 R2100	BJS551	1SNA 205 778 R2100
BJS551	1SNA 205 779 R2200	BJS551	1SNA 205 779 R2200
DRF12	1SNA 205 770 R2500	DRF16	1SNA 205 771 R1200
On cover :	RC810	On the middle :	RC810 or RPC

Power terminal blocks

DIN3 with bistable foot and base mounting

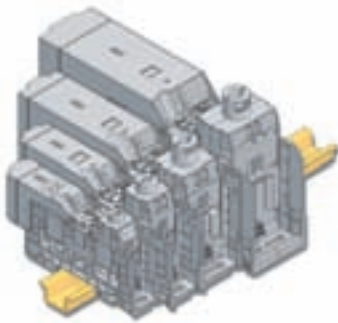

Delivered with cover

Rail		35 x 7,5 x 1	PR3.Z2	1SNA 174 300 R1700
Rail		35 x 15 x 2,3	PR4	1SNA 168 500 R1200
Rail		35 x 15 x 1,5	PR5	1SNA 168 700 R2200

Other rails : see section on accessories.

Notes

* NFC 20130
** DIN 46234

Base mounting with M6 screws.
See drilling next page.

Accessories

	1	End stop (other end stops : see accessories)
	2	Rotating protective cover IP 20
	3	Jumper bar with CHC screws 2 poles 3 poles
	4	TAP for Faston 6.35 x 0.8 mm and screw
	R	See marking chapter Marking method

D 35/27.AF

Spacing 27 mm (1.06")

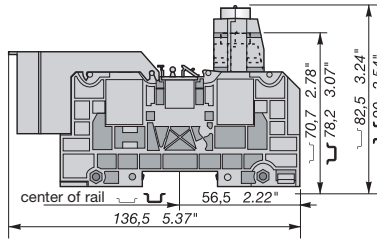

1 stud M6 + 1 wire-clamp with CHC M6 screw



D 70/32.AF

Spacing 32 mm (1.26")

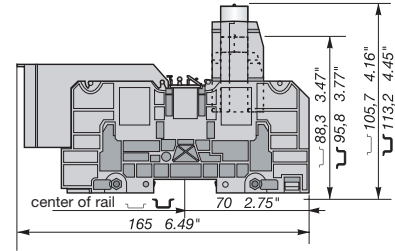

1 stud M8 + 1 wire-clamp with CHC M8 screw



Color	Type	Part number
Grey V0		D35/27.AF 1SNA 190 006 R2500

Delivered with covers

Color	Type	Part number
Grey V0		D 70/32.AF 1SNA 190 007 R2600

Delivered with covers

Characteristics

Wire size	Wire size			
	NFC*	DIN**	UL	CSA
Lug Rigid	2,5-35 mm ²	2,5-50 mm ²		1-12 AWG
C4* Flexible	2,5-35 mm ²	2,5-35 mm ²		1-12 AWG
Wire-clamp Rigid	2,5-40 mm ²			
IEC B9 Flexible	2,5-35 mm ²			

Rated voltage	IEC	IEC	
V =~	1000	1000	600
Impulse withstand	8 kV	8 kV	
Pollution degree	3	3	
Rated current	IEC		
Nominal	125 A		130 A

Rated wire size			
Nominal	35 mm ²		
Lug	Central screw	Wire-clamp	Wire stripping length
H 10 mm	6 mm Allen key	5 mm Allen Key	28 mm
Recommended wrench	3-6 Nm/26.1/52 lb.in	6-12 Nm/52-104 lb.in	3-6 Nm/26.1/52 lb.in
Recommended torque			

Characteristics

Wire size	Wire size			
	NFC*	DIN**	UL	CSA
Lug Rigid	6-95 mm ²	6-70 mm ²		000-10 AWG
C6* Flexible	6-70 mm ²	6-70 mm ²		000-10 AWG
Wire-clamp Rigid	6-95 mm ²			
IEC B11 Flexible	6-70 mm ²			

Rated voltage	IEC	IEC	
V =~	1000	1000	600
Impulse withstand	8 kV	8 kV	
Pollution degree	3	3	
Rated current	IEC		
Nominal	192 A		165 A

Rated wire size			
Nominal	70 mm ²		
Lug	Central screw	Wire-clamp	Wire stripping length
H 13 mm	6 mm Allen key	6 mm Allen Key	33 mm
Recommended wrench	6-12 Nm/52-104 lb.in	6-12 Nm/52-104 lb.in	6-12 Nm/52-104 lb.in
Recommended torque			

Type	Part number
BADH	th. 12 mm 1SNA 116 900 R2700
CPUF35	V0 grey 1SNA 190 016 R1600
BJS27	1SNA 205 772 R1300
BJS27	1SNA 205 773 R1400
DRF6	1SNA 205 767 R1600

Type	Part number
BADH	th. 12 mm 1SNA 116 900 R2700
CPUF70	V0 grey 1SNA 190 017 R1700
BJS32	1SNA 205 774 R1500
BJS32	1SNA 205 775 R1600
DRF8	1SNA 205 768 R2700

On cover :	On the middle :
RC810	RC810 or RPC

On cover :	On the middle :
RC810	RC810 or RPC

Power terminal blocks

DIN3 with bistable foot and base mounting

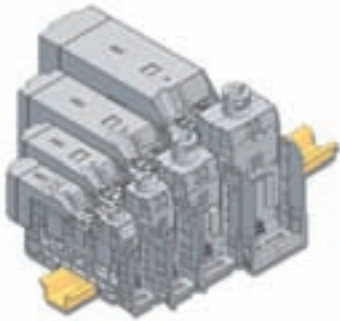

Delivered with cover

Rail		35 x 7,5 x 1	PR3.Z2	1SNA 174 300 R1700
Rail		35 x 15 x 2,3	PR4	1SNA 168 500 R1200
Rail		35 x 15 x 1,5	PR5	1SNA 168 700 R2200

Other rails : see section on accessories.

Notes

* NFC 20130
** DIN 46234

Base mounting with M6 screws.
See drilling next page.

Accessories

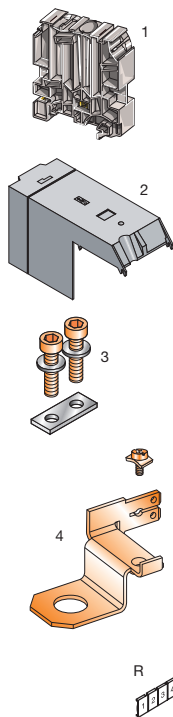

- End stop (other end stops : see accessories)
- Rotating protective cover IP 20
- Jumper bar with CHC screws
2 poles
3 poles
- TAP for Faston 6.35 x 0.8 mm and screw

R See marking chapter
Marking method

D 120/42.AF

Spacing 42 mm (1.65")

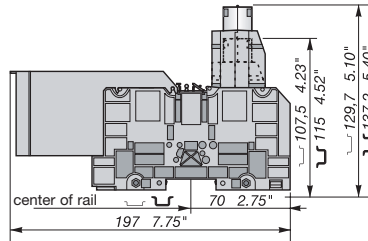

1 stud M10 + wire clamp with CHC M10 screw



Color	Type	Part number
Grey V0		D120/42.AF 1SNA 190 008 R0700

Delivered with covers

Characteristics

Wire size		NFC*	DIN**	UL	CSA
Lug	Rigid	6-150 mm ²	6-120 mm ²		300-10 AWG
C8*	Flexible	6-120 mm ²	6-120 mm ²		300-10 AWG
Wire-clamp	Rigid	6-150 mm ²			
IEC B13	Flexible	6-120 mm ²			

Rated voltage	IEC	IEC	
V =~	1000	1000	600
Impulse withstand	8 kV	8 kV	
Pollution degree	3	3	
Rated current	IEC		
Nominal	269 A		240 A

Rated wire size			
Nominal	120 mm ²		
Lug	Central screw	Wire-clamp	Wire stripping length
H 17 mm	6 mm Allen key	8 mm Allen key	38 mm
Recommended wrench	10-20 Nm/87-174 lb.in	6-12 Nm/52-104 lb.in	10-20 Nm/87-174 lb.in
Recommended torque			7.50"

D 185/55.AF

Spacing 55 mm (2.16")

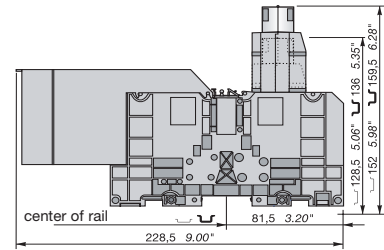

1 stud M12 + wire clamp with CHC M12 screw



Color	Type	Part number
Grey V0		D185/55.AF 1SNA 190 009 R0000

Delivered with covers

Characteristics

Wire size		NFC*	DIN**	UL	CSA
Lug	Rigid	25-240 mm ²	6-185 mm ²		500-4 AWG
C11*	Flexible	6-185 mm ²	6-185 mm ²		500-4 AWG
Wire-clamp	Rigid	25-240 mm ²			
IEC B15	Flexible	25-185 mm ²			

Rated voltage	IEC	IEC	
V =~	1000	1000	600
Impulse withstand	8 kV	8 kV	
Pollution degree	3	3	
Rated current	IEC		
Nominal	353 A		320 A

Rated wire size			
Nominal	185 mm ²		
Lug	Central screw	Wire-clamp	Wire stripping length
H 19 mm	6 mm Allen key	10 mm Allen key	47 mm
Recommended wrench	14-30 Nm/121-261 lb.in	6-12 Nm/52-104 lb.in	14-20 Nm/121-174 lb.in
Recommended torque			7.85"

Accessories

Type	Part number
BADH	th. 12 mm 1SNA 116 900 R2700
CPUF120	V0 grey 1SNA 190 018 R2000
BJS42	1SNA 205 776 R1700
BJS42	1SNA 205 777 R1000
DRF10	1SNA 205 769 R2000

Accessories

Type	Part number
BADH	th. 12 mm 1SNA 116 900 R2700
CPUF185	V0 grey 1SNA 190 019 R2100
BJS551	1SNA 205 778 R2100
BJS551	1SNA 205 779 R2200
DRF12	1SNA 205 770 R2500

On cover : RC810
On the middle : RC810 or RPC

On cover : RC810
On the middle : RC810 or RPC

Drilling for panel mounting and dimensions with the covers

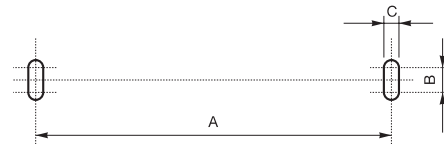
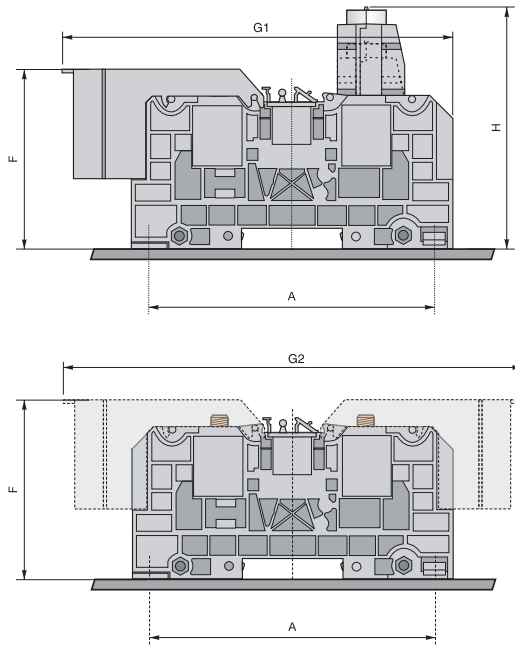

D 35/27.AF - D 70/32.AF - D 120/42.AF
 D 35/27.FF - D 70/32.FF - D 120/42.FF

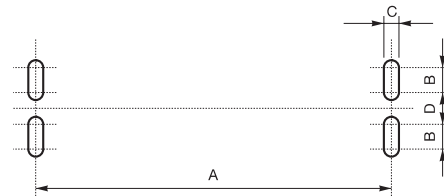

D 185/55.AF
 D 185/55.FF - D 300/55.FF

Type	Mounting with :	A	B	C	D	F	G1	G2	H
D 35/27...	2 Screws	100,5	7,5	6,5	/	63,5	136,5	160	82,5
D 70/32...	2 Screws	120	7,5	6,5	/	72,5	165	190,5	105,7
D 120/42...	2 Screws	120	7,5	6,5	/	83,5	197	255,5	129,7
D 185/55...	4 Screws	135	13,5	6,5	8,5	103,5	228,5	295	151,5
D 300/55...	4 Screws	135	13,5	6,5	8,5	105	/	295	/

Dimensions in mm.

Marking

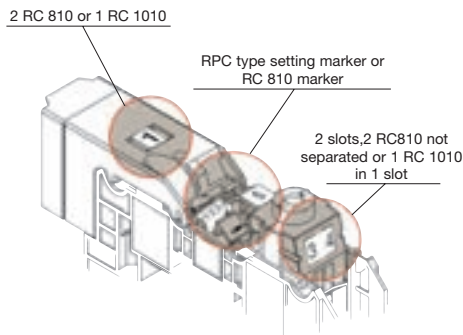

Jumper bar

- move the marker holders up
- cut out the partition
- screw the jumper bar

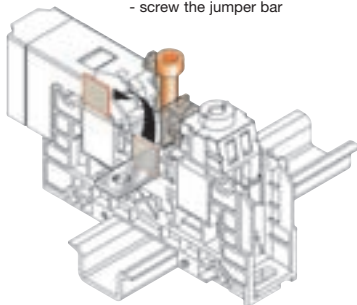

Locking foot operating with screwdriver DIA. 4

Center opening (to be made after jumper bar has been removed) "monostable action".
 As soon as the screwdriver is removed, the locking foot comes back to closed position

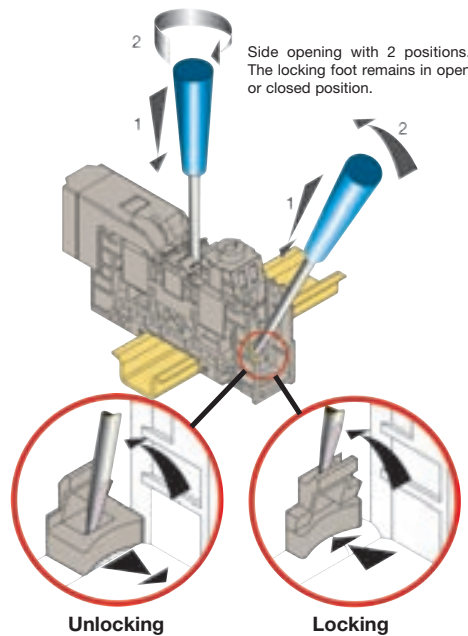

Locking

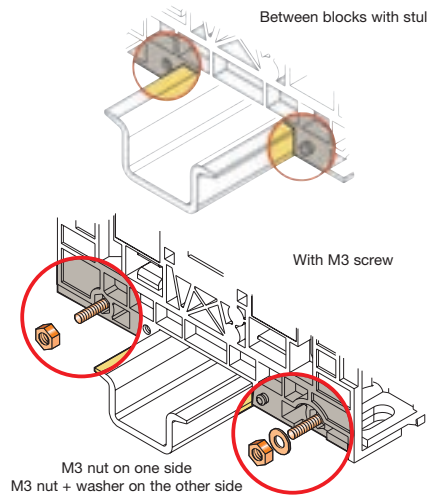

Mounting of the derivative system

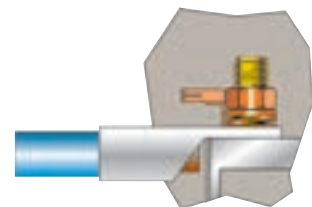



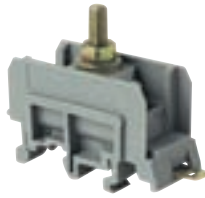

Power terminal blocks

Type I

 **DIN 1 - DIN 3**



The use of some accessories may decrease the block's voltage rating. For more information, consult us.

Rail		35 x 7,5 x 1	PR3.Z2	1SNA 174 300 R1700
Rail		35 x 15 x 2,3	PR4	1SNA 168 500 R1200
Rail		35 x 15 x 1,5	PR5	1SNA 168 700 R2200
Rail		32 x 15 x 1,5	PR1.Z2	1SNA 163 050 R0400

Other end stops, rails and accessories : see section on accessories.

Notes

D
2

M 35/26.F

Spacing 26 mm (1.02")

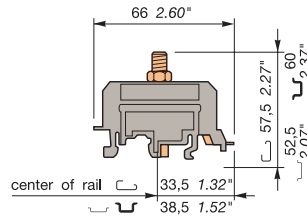

1 stud M6



Color	Type	Part number
Grey	<input type="checkbox"/> M 35/26.F	1SNA 115 141 R1000

M 70/31.F

Spacing 31 mm (1.22")

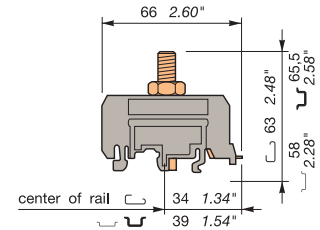

1 stud M8



Color	Type	Part number
Grey	<input type="checkbox"/> M 70/31.F	1SNA 115 144 R1300

Characteristics

Wire size	Wire size			
	DIN	NFC	UL	CSA
Lug	2,5-50 mm ²	4-35 mm ²	10-2 AWG	4 AWG max.
Bar	16 x 4 mm .63" x .16"			
Wire-clamp				
Voltage	Voltage		Voltage	
	IEC	IEC	IEC	IEC
V~ Without partition	1000	1000	600	600
V~ With partition	1000	1000	600	600
Impulse withstand	8 kV	8 kV		
Pollution degree	3	3		
Current	Current		Current	
	DIN	NFC	DIN	NFC
Rated	125 A	101 A	115 A	125 A
Wire size	Wire size			
	Rated / Gauge	35 mm ²	25 mm ²	2 AWG
Lug		Wire clamp	Wire stripping length	
Recommended wrench	H 10 mm			
Recommended torque	4,5 Nm 39 lb.in			

Characteristics

Wire size	Wire size			
	DIN	NFC	UL	CSA
Lug	2,5-70 mm ²	6-70 mm ²	4-00 AWG	0 AWG max.
Bar	20 x 5 mm .78" x .20"			
Wire-clamp				
Voltage	Voltage		Voltage	
	IEC	IEC	IEC	IEC
V~ Without partition	1000	1000	600	600
V~ With partition	1000	1000	600	600
Impulse withstand	8 kV	8 kV		
Pollution degree	3	3		
Current	Current		Current	
	DIN	NFC	DIN	NFC
Rated	150 A	150 A	175 A	200 A
Wire size	Wire size			
	Rated/gauge	50 mm ²	50 mm ²	00 AWG
Lug		Wire clamp	Wire stripping length	
Recommended wrench	H 13 mm			
Recommended torque	6 Nm 52 lb.in			

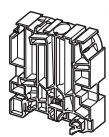

Accessories



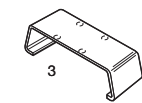
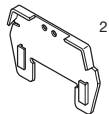

- End stop (other end stop: see accessories)
- Partition for cover
- Protective cover (marked cut)

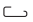
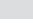

R See section on markers
Marking method

Type	Part number
BAEH 	th. 12 mm 1SNA 116 934 R0400
BADH 	th. 12 mm 1SNA 116 900 R2700
BAMH 	th. 9,1 mm 1SNA 114 836 R0000
ECP26 	1SNA 113 689 R2400
CPP261	1 block 1SNA 168 202 R1300
CPP262	2 blocks 1SNA 168 201 R1200
CPP263	3 blocks 1SNA 163 403 R2000

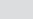
Type	Part number
BAEH 	th. 12 mm 1SNA 116 934 R0400
BADH 	th. 12 mm 1SNA 116 900 R2700
BAMH 	th. 9,1 mm 1SNA 114 836 R0000
ECP31 	1SNA 113 690 R2100
CPP311	1 block 1SNA 168 204 R1500
CPP312	2 blocks 1SNA 168 203 R1400
CPP313	3 blocks 1SNA 163 409 R0600

PEP+RC610 for ECP RC610 for CPU cover

PEP+RC610 for ECP RC610 for CPU cover

M 120/35.F

Spacing 35 mm (1.38")

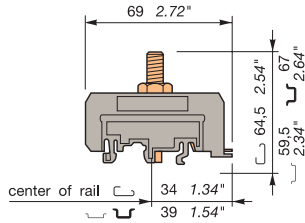

1 stud M8

M 300/42.F

Spacing 42 mm (1.65")

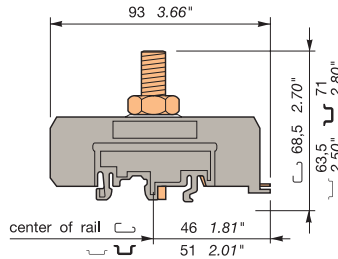

1 stud M10

M 35/26.FF

Spacing 26 mm (1.02")

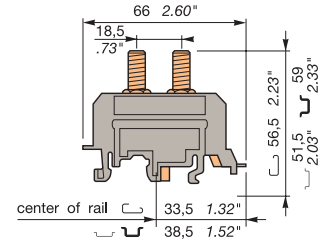

2 studs M6 linked by
1 removable bar 15 x 4 mm



Color	Type	Part number	Color	Type	Part number	Color	Type	Part numbers
Grey	<input type="checkbox"/> M 120/35.F	1SNA 115 147 R1600	Grey	<input type="checkbox"/> M 300/42.F	1SNA 115 150 R2500	Grey	<input type="checkbox"/> M 35/26.FF	1SNA 115 140 R2300
	<input type="checkbox"/>			<input type="checkbox"/>		Beige V0	<input type="checkbox"/> M 35/26.FF.V0	1SNA 195 140 R2400

Characteristics

Wire size	Wire size			
	DIN	NFC	UL	CSA
Lug	2,5-70 mm ²	6-95 mm ²	2-250 MCM	000 AWG max.
Bar	25 x 5 mm		1" x .20"	
Wire-clamp	IEC	IEC		
Voltage	Voltage			
	IEC	IEC		
V~ Without partition	1000	1000	600	600
V~ With partition	1000	1000	600	600
Impulse withstand	8 kV	8 kV		
Pollution degree	3	3		
Current	Current			
	DIN	NFC		
Rated	150 A	192 A	255 A	270 A

Characteristics

Wire size	Wire size			
	DIN	NFC	UL	CSA
Lug	6-150 mm ²	50-150 mm ²	0-500 MCM	500 MCM
Bar	32 x 8 mm		1.26" x .32"	
Wire-clamp	IEC	IEC		
Voltage	Voltage			
	IEC	IEC		
V~ Without partition	1000	1000	600	600
V~ With partition	1000	1000	600	600
Impulse withstand	8 kV	8 kV		
Pollution degree	3	3		
Current	Current			
	DIN	NFC		
Rated	269 A	269 A	230 A	550 A

Characteristics

Wire size	Wire size			
	DIN	NFC	UL	CSA
Lug	2,5-50 mm ²	4-35 mm ²	10-2 AWG	4 AWG max.
Bar	16 x 4 mm		.63" x .16"	
Wire-clamp	IEC	IEC		
Voltage	Voltage			
	IEC	IEC		
V~ Without partition	1000	1000	600	600
V~ With partition	1000	1000	600	600
Impulse withstand	8 kV	8 kV		
Pollution degree	3	3		
Current	Current			
	DIN	NFC		
Rated	125 A	101 A	115 A	125 A

Wire-size				
Rated	50 mm ²	70 mm ²	250 MCM	000 AWG
Lug	Central bolt	Wire-clamp	Wire stripping length	
H 13 mm				
6 Nm 52 lb.in				

Wire-size				
Rated	120 mm ²	120 mm ²	500 MCM	500 MCM
Lug	Central bolt	Wire-clamp	Wire stripping length	
H 16 mm				
10 Nm 87 lb.in				

Wire-size				
Rated	35 mm ²	25 mm ²	2 AWG	4 AWG
Lug	Central bolt	Wire-clamp	Wire stripping length	
H 10 mm				
4,5 Nm 39 lb.in				

Type	Part numbers				Type	Part numbers				Type	Part numbers			
BAEH		th. 12 mm	1SNA 116 934 R0400		BAEH		th. 12 mm	1SNA 116 934 R0400		BAEH		th. 12 mm	1SNA 116 934 R0400	
BADH		th. 12 mm	1SNA 116 900 R2700		BADH		th. 12 mm	1SNA 116 900 R2700		BADH		th. 12 mm	1SNA 116 900 R2700	
BAMH		th. 9,1 mm	1SNA 114 836 R0000		BAMH		th. 9,1 mm	1SNA 114 836 R0000		BAMH		th. 9,1 mm	1SNA 114 836 R0000	
ECP35			1SNA 113 691 R1600		ECP42			1SNA 113 692 R1700		ECP26			1SNA 113 689 R2400	
CPP351		1 block	1SNA 168 206 R1700		CPP421		1 block	1SNA 168 208 R2100		CPP261		1 block	1SNA 168 202 R1300	
CPP352		2 blocks	1SNA 168 205 R1600		CPP422		2 blocks	1SNA 168 207 R1000		CPP262		2 blocks	1SNA 168 201 R1200	
CPP353		3 blocks	1SNA 163 418 R2600		CPP423		3 blocks	1SNA 163 424 R1400		CPP263		3 blocks	1SNA 163 403 R2000	

PEP+RC610 for ECP RC610 for CPU cover

PEP+RC610 for ECP RC610 for CPU cover

PEP+RC610 for ECP RC610 for CPU cover

Power terminal blocks

Type I

DIN 1 - DIN 3

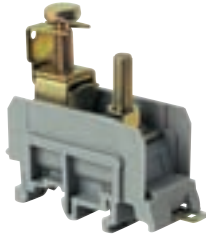
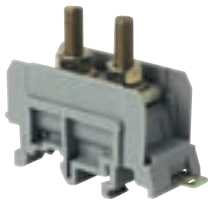

Rail		35 x 7,5 x 1	PR3.Z2	1SNA 174 300 R1700
Rail		35 x 15 x 2,3	PR4	1SNA 168 500 R1200
Rail		35 x 15 x 1,5	PR5	1SNA 168 700 R2200
Rail		32 x 15 x 1,5	PR1.Z2	1SNA 163 050 R0400

Other end stops, rails and accessories : see section on accessories.

Notes

D
2

M 70/31.FF

Spacing 31 mm (1.22")

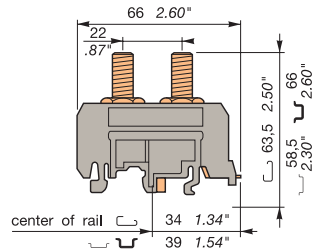

2 studs M8 linked by
1 removable bar 20 x 5 mm



Color	Type	Part numbers
Grey		M 70/31.FF 1SNA 115 143 R1200

M 120/35.FF

Spacing 35 mm (1.38")

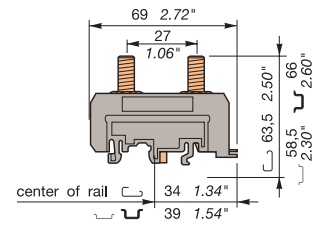

2 studs M8 linked by
1 removable bar 25 x 5 mm



Color	Type	Part numbers
Grey		M 120/35.FF 1SNA 115 146 R1500

Characteristics

Wire size	Wire size			
	DIN	NFC	UL	CSA
Lug	2,5-70 mm ²	6-70 mm ²	4-00 AWG	0 AWG max.
Bar	20 x 5 mm .78" x .20"			
Wire-clamp				

Voltage	Voltage			
	IEC	IEC		
V~ Without partition	1000-1200	1000	600	600
V~ With partition	1000-1200	1000	600	600
Impulse withstand	8 kV	8 kV		
Pollution degree	3	3		

Current	Current			
	DIN	NFC		
Rated	178 A	150 A	175 A	200 A

Wire size	Wire size			
	DIN	NFC	UL	CSA
Rated / Gauge	50 mm ²	50 mm ²	2/0 AWG	0 AWG
Lug	Central bolt	Wire clamp	Wire stripping length	

Recommended wrench	H 13 mm
Recommended torque	6 Nm 52 lb.in

Characteristics

Wire size	Wire size			
	DIN	NFC	UL	CSA
Lug	2,5-70 mm ²	6-95 mm ²	2-250 MCM	000 AWG max.
Bar	25 x 5 mm 1" x .20"			
Wire-clamp				

Voltage	Voltage			
	IEC	IEC		
V~ Without partition	1000-1200	1000	600	600
V~ With partition	1000-1200	1000	600	600
Impulse withstand	8 kV	8 kV		
Pollution degree	3	3		

Current	Current			
	DIN	NFC		
Rated	220 A	192 A	255 A	270 A

Wire size	Wire size			
	DIN	NFC	UL	CSA
Rated/gauge	70 mm ²	70 mm ²	250 MCM	000 AWG
Lug	Central bolt	Wire clamp	Wire stripping length	

Recommended wrench	H 13 mm
Recommended torque	6 Nm 52 lb.in

Accessories

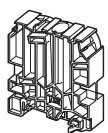

1 End stop
(other end stops : see accessories)

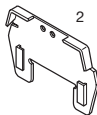

2 Partition for cover
3 Protective cover
(marked cut)

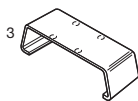

R See section on markers
Marking method

Type	Part numbers		
BAEH	th. 12 mm	1SNA 116 934 R0400	
BADH	th. 12 mm	1SNA 116 900 R2700	
BAMH	th. 9,1 mm	1SNA 114 836 R0000	
ECP31		1SNA 113 690 R2100	
CPP311	1 block	1SNA 168 204 R1500	
CPP312	2 blocks	1SNA 168 203 R1400	
CPP313	3 blocks	1SNA 163 409 R0600	

Type	Part numbers		
BAEH	th. 12 mm	1SNA 116 934 R0400	
BADH	th. 12 mm	1SNA 116 900 R2700	
BAMH	th. 9,1 mm	1SNA 114 836 R0000	
ECP35		1SNA 113 691 R1600	
CPP351	1 block	1SNA 168 206 R1700	
CPP352	2 blocks	1SNA 168 205 R1600	
CPP353	3 blocks	1SNA 163 418 R2600	

PEP+RC610 for ECP RC610 for CPU cover

M 300/42.FF

Spacing 42 mm (1.65")

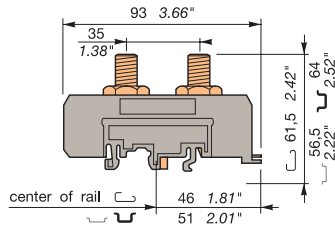

2 studs M10 linked by
1 removable bar 31,5 x 5 mm

M 35/26.AF

Spacing 26 mm (1.02")

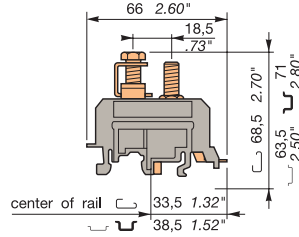

1 stud M6
1 wire-clamp with HM6 screw

M 70/31.AF

Spacing 31 mm (1.22")

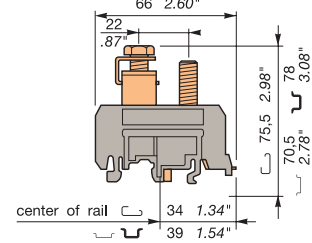

1 stud M8
1 wire-clamp with HM8 screw

	Color	Type	Part numbers		Color	Type	Part number		Color	Type	Part number
	Grey	M 300/42.FF	1SNA 115 149 R2000		Grey	M 35/26.AF	1SNA 115 139 R1600		Grey	M 70/31.AF	1SNA 115 142 R1100

Characteristics

Wire size				
	DIN	NFC	UL	CSA
Lug	6-150 mm ²	50-150 mm ²	1/0-500 MCM	500 MCM max.
Bar	32 x 8 mm		1.26" x .32"	
Voltage				
	IEC			
V~ Without partition	1000	1000	600	600
V~ With partition	1000	1000	600	600
Impulse withstand	12 kV	12 kV		
Pollution degree	3	3		
Current				
	DIN	NFC		
Rated	265 A	269 A	230 A	550 A

Wire-size				
Rated	95 mm ²	120 mm ²	500 MCM	500 MCM
Lug	Central bolt	Wire-clamp	Wire stripping length	
H 16 mm				
10 Nm 87 lb.in				

Type	Part numbers			
BAEH	th. 12 mm	1SNA 116 934 R0400		
BADH	th. 12 mm	1SNA 116 900 R2700		
BAMH	th. 9,1 mm	1SNA 114 836 R0000		
ECP42		1SNA 113 692 R1700		
CPP421	1 block	1SNA 168 208 R2100		
CPP422	2 blocks	1SNA 168 207 R1000		
CPP423	3 blocks	1SNA 163 424 R1400		

PEP+RC610 for ECP RC610 for CPU cover

Characteristics

Wire size				
	DIN	NFC	UL	CSA
Lug	2,5-50 mm ²	4-35 mm ²	10-2 AWG	4 AWG max.
Bar	16 x 4 mm		.63" x .16"	
Voltage				
	IEC			
V~ Without partition	1000-1200	1000	600	600
V~ With partition	1000-1200	1000	600	600
Impulse withstand	8 kV	8 kV		
Pollution degree	3	3		
Current				
	DIN	NFC		
Rated	115 A	101 A	115 A	125 A

Wire-size				
Rated	25 mm ²	25 mm ²	2 AWG	4 AWG
Lug	Central bolt	Wire-clamp	Wire stripping length	
H 10 mm		H 10 mm	19 mm .75"	
4,5 Nm 39 lb.in		4,5 Nm 39 lb.in		

Type	Part numbers			
BAEH	th. 12 mm	1SNA 116 934 R0400		
BADH	th. 12 mm	1SNA 116 900 R2700		
BAMH	th. 9,1 mm	1SNA 114 836 R0000		
ECP26		1SNA 113 689 R2400		
CPP261	1 block	1SNA 168 202 R1300		
CPP262	2 blocks	1SNA 168 201 R1200		
CPP263	3 blocks	1SNA 163 403 R2000		

for ECP and wire-clamp for CPU cover

Characteristics

Wire size				
	DIN	NFC	UL	CSA
Lug	2,5-70 mm ²	6-70 mm ²	8-0 AWG	6-0 AWG
Bar	20 x 5 mm		.78" x .20"	
Voltage				
	IEC			
V~ Without partition	1000-1200	1000	600	600
V~ With partition	1000-1200	1000	600	600
Impulse withstand	8 kV	8 kV		
Pollution degree	3	3		
Current				
	DIN	NFC		
Rated	178 A	150 A	150 A	200 A

Wire-size				
Rated	50 mm ²	50 mm ²	1/0 AWG	0 AWG
Lug	Central bolt	Wire-clamp	Wire stripping length	
H 13 mm		H 13 mm	22 mm .87"	
6 Nm 52 lb.in		6 Nm 52 lb.in		

Type	Part numbers			
BAEH	th. 12 mm	1SNA 116 934 R0400		
BADH	th. 12 mm	1SNA 116 900 R2700		
BAMH	th. 9,1 mm	1SNA 114 836 R0000		
ECP31		1SNA 113 690 R2100		
CPP311	1 block	1SNA 168 204 R1500		
CPP312	2 blocks	1SNA 168 203 R1400		
CPP313	3 blocks	1SNA 163 409 R0600		

for ECP and wire-clamp for CPU cover

Power terminal blocks

Type I

DIN 1 - DIN 3

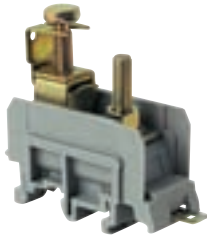

Rail		35 x 7,5 x 1	PR3.Z2	1SNA 174 300 R1700
Rail		35 x 15 x 2,3	PR4	1SNA 168 500 R1200
Rail		35 x 15 x 1,5	PR5	1SNA 168 700 R2200
Rail		32 x 15 x 1,5	PR1.Z2	1SNA 163 050 R0400

Other end stops, rails and accessories : see section on accessories.

Notes

D
2

M 120/35.AF

Spacing 35 mm (1.38")

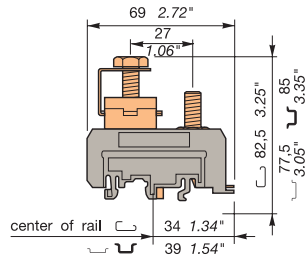

1 stud M8
1 wire-clamp with HM8 screw

M 300/42.AF

Spacing 42 mm (1.65")

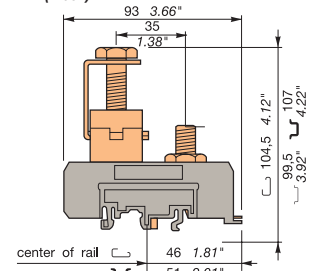

1 stud M10
1 wire-clamp with HM10 screw



Color	Type	Part number	Color	Type	Part number
Grey		M 120/35.AF 1SNA 115 145 R1400	Grey		M 300/42.AF 1SNA 115 148 R2700

Characteristics

Wire size	DIN	NFC	UL	CSA
	Lug	2,5-70 mm ²	6-95 mm ²	2-250 MCM
Bar	25 x 5 mm		.1" x .20"	
Wire-clamp	35-120 mm ²	35-120 mm ²	2-250 MCM	2-000 AWG

Voltage	IEC		IEC	
	V~	Without partition	1000	1000
	With partition	1000	1000	600
Impulse withstand	8 kV	8 kV		
Pollution degree	3	3		

Current	DIN	NFC	UL	CSA
Rated	150 A	192 A	255 A	270 A

Wire size	50 mm ²	70 mm ²	250 MCM	000 AWG
	Rated / Gauge			
Lug				
Central bolt				
Wire clamp				
Wire stripping length				

Recommended wrench	H 13 mm		H 13 mm	28 mm 1.10"
Recommended torque	6 Nm 52 lb.in		6 Nm 52 lb.in	

Characteristics

Wire size	DIN	NFC	UL	CSA
	Lug	6-150 mm ²	50-150 mm ²	0-500 MCM
Bar	32 x 8 mm		1.26" x .32"	
Wire-clamp	70-300 mm ²	70-300 mm ²	0-500 MCM	0-500 MCM

Voltage	IEC		IEC	
	V~	Without partition	1000	1000
	With partition	1000	1000	600
Impulse withstand	8 kV	8 kV		
Pollution degree	3	3		

Current	DIN	NFC	UL	CSA
Rated	269 A	269 A	380 A	550 A

Wire size	120 mm ²	120 mm ²	500 MCM	500 MCM
	Rated/gauge			
Lug				
Central bolt				
Wire clamp				
Wire stripping length				

Recommended wrench	H 16 mm		H 16 mm	40 mm 1.58"
Recommended torque	10 Nm 87 lb.in		10 Nm 87 lb.in	

Accessories

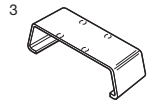
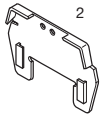
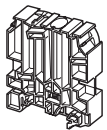

- End stop (other end stops : see accessories)
- Partition for cover
- Protective cover (marked cut)

R See section on markers
Marking method

Type	Part numbers
BAEH	th. 12 mm 1SNA 116 934 R0400
BADH	th. 12 mm 1SNA 116 900 R2700
BAMH	th. 9,1 mm 1SNA 114 836 R0000
ECP35	1SNA 113 691 R1600
CPP351	1 block 1SNA 168 206 R1700
CPP352	2 blocks 1SNA 168 205 R1600
CPP353	3 blocks 1SNA 163 418 R2600

Type	Part numbers
BAEH	th. 12 mm 1SNA 116 934 R0400
BADH	th. 12 mm 1SNA 116 900 R2700
BAMH	th. 9,1 mm 1SNA 114 836 R0000
ECP42	1SNA 113 692 R1700
CPP421	1 block 1SNA 168 208 R2100
CPP422	2 blocks 1SNA 168 207 R1000
CPP423	3 blocks 1SNA 163 424 R1400

PEP+RC610 for ECP and wire-clamp RC610 for CPU cover

PEP+RC610 for ECP and wire-clamp RC610 for CPU cover

Notes



Power terminal blocks

Type II

 **DIN 1 - DIN 3**



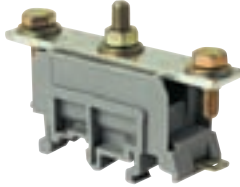

Partition required



DIN mounted power blocks after the flexibility and safety associated with other entrelec blocks:

- with 2 screws
- with 2 wire clamps
- with 1 screw - 1 wire clamp

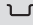
The use of some accessories may decrease the block's voltage rating. For more information, consult us.

Rail		35 x 7,5 x 1	PR3.Z2	1SNA 174 300 R1700
Rail		35 x 15 x 2,3	PR4	1SNA 168 500 R1200
Rail		35 x 15 x 1,5	PR5	1SNA 168 700 R2200
Rail		32 x 15 x 1,5	PR1.Z2	1SNA 163 050 R0400

Other end stops, rails and accessories : see section on accessories

Notes

D
2

M 35/26.EE

Spacing 26 mm (1.02")
see size on following pages

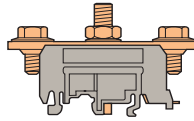

1 stud 15 x 3 with
- 2 screws HM6 for lug or bar
- 1 central bolt HM6 for transversal connection

M 70/31.EE

Spacing 31 mm (1.22")
see size on following pages

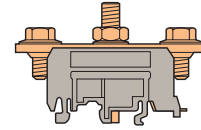

1 stud 20 x 3 with
- 2 screws HM8 for lug or bar
- 1 central bolt HM8 for transversal connection



Color	Type	Part numbers	Color	Type	Part numbers
Grey	<input type="checkbox"/>	M 35/26.EE 1SNA 115 151 R1200	Grey	<input type="checkbox"/>	M 70/31.EE 1SNA 115 154 R1500
Beige V0	<input type="checkbox"/>	M 35/26.EE.V0 1SNA 195 151 R1300	Beige V0	<input type="checkbox"/>	M 70/31.EE.V0 1SNA 195 154 R1600

Characteristics

Wire size	Wire size			
	DIN	NFC	UL	CSA
Lug	2,5-35 mm ²	4-35 mm ²	10-2 AWG	4 AWG max.
Bar	15 x 3 mm .59" x .12"			
Wire-clamp				

Voltage	Voltage			
	IEC	IEC		
V~ Without partition				
V~ With partition	1000	1000	600	600
Impulse withstand	12 kV	12 kV		
Pollution degree	3	3		

Current	Current			
	DIN	NFC		
Rated	101 A	101 A	115 A	125 A

Wire size	Wire size			
	Rated / Gauge	25 mm ²	25 mm ²	2 AWG 4 AWG
Lug		central bolt	Wire clamp	Wire stripping length

Recommended wrench	H 10 mm	H 10 mm		
Recommended torque	4,5 Nm 39 lb.in	4,5 Nm 39 lb.in		

Characteristics

Wire size	Wire size			
	DIN	NFC	UL	CSA
Lug	2,5-70 mm ²	6-70 mm ²	4-00 AWG	0 AWG max.
Bar	20 x 3 mm .78" x .12"			
Wire-clamp				

Voltage	Voltage			
	IEC	IEC		
V~ Without partition				
V~ With partition	1000	1000	600	600
Impulse withstand	12 kV	12 kV		
Pollution degree	3	3		

Current	Current			
	DIN	NFC		
Rated	150 A	150 A	175 A	200 A





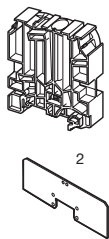

Wire size	Wire size			
	Rated/gauge	50 mm ²	50 mm ²	00 AWG 0 AWG
Lug		central bolt	Wire clamp	Wire stripping length

Recommended wrench	H 13 mm	H 13 mm		
Recommended torque	6 Nm 52 lb.in	6 Nm 52 lb.in		

Accessories



- 1 End stop (other end stop: see accessories)
- 2 Partition











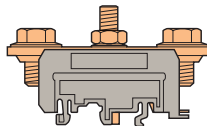
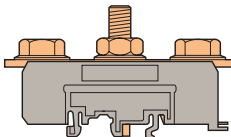
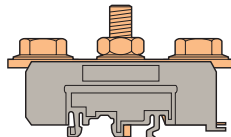

Type	Part numbers	Type	Part numbers
BAEH 	th. 12 mm 1SNA 116 934 R0400	BAEH 	th. 12 mm 1SNA 116 934 R0400
BADH 	th. 12 mm 1SNA 116 900 R2700	BADH 	th. 12 mm 1SNA 116 900 R2700
BAMH 	th. 9,1 mm 1SNA 114 836 R0000	BAMH 	th. 9,1 mm 1SNA 114 836 R0000
ECS26	1SNA 168 838 R0000	ECS26	1SNA 168 838 R0000

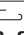

R See section on markers
Marking method

PEP+RC610 for ECS RC610 for CPU

PEP+RC610 for ECS RC610 for CPU

M 150/35.EE					M 300/42.EE1					M 185/42.EE				
Spacing 35 mm (1.38") see size on following pages					Spacing 42 mm (1.65") see size on following pages					Spacing 42 mm (1.65") see size on following pages				
														
1 stud 25 x 3,15 with - 2 screws HM10 for lug or bar - 1 central bolt HM8 for transversal connection					1 stud 31,5 x 3,15 with - 2 screws HM10 for lug or bar - 1 central bolt HM10 for transversal connection					1 stud 31,5 x 3,15 with - 2 screws HM12 for lug or bar - 1 central bolt HM10 for transversal connection				
														
Color	Type	Part number			Color	Type	Part number			Color	Type	Part number		
Grey	<input type="checkbox"/>	M 150/35.EE	1SNA 115 156	R1700	Grey	<input type="checkbox"/>	M 300/42.EE1	1SNA 115 195	R0700	Grey	<input type="checkbox"/>	M 185/42.EE	1SNA 115 159	R2200
Characteristics					Characteristics					Characteristics				
Wire size					Wire size					Wire size				
Lug	DIN	NFC	UL	CSA	Lug	DIN	NFC	UL	CSA	Lug	DIN	NFC	UL	CSA
	6-120 mm ²	10-95 mm ²	14-250 MCM	000 AWG max.		6-150 mm ²	10-150 mm ²	8-350 MCM	250 MCM		6-150 mm ²	10-150 mm ²	14-300 MCM	250 MCM
Bar	25 x 3,15 mm		1" x .124"		Bar	31,5 x 3,15 mm		1.24" x .124"		Bar	31,5 x 3,15 mm		1.24" x .124"	
Voltage					Voltage					Voltage				
V~	Without partition				V~	Without partition				V~	Without partition			
	With partition		600			With partition		600			With partition		600	
Impulse withstand	12 kV	12 kV			Impulse withstand	8 kV	8 kV			Impulse withstand	12 kV	12 kV		
Pollution degree	3	3			Pollution degree	3	3			Pollution degree	3	3		
Current					Current					Current				
Rated	DIN	NFC			Rated	DIN	NFC			Rated	DIN	NFC		
	232 A	192 A	255 A	270 A		269 A	269 A	310 A	310 A		269 A	269 A	285 A	310 A
Wire-size					Wire-size					Wire-size				
Rated	95 mm ²	70 mm ²	250 MCM	000 AWG	Rated	120 mm ²	120 mm ²	250 MCM	250 MCM	Rated	120 mm ²	120 mm ²	300 MCM	250 MCM
Lug	Central bolt	Wire-clamp	Wire stripping length		Lug	Central bolt	Wire-clamp	Wire stripping length		Lug	Central bolt	Wire-clamp	Wire stripping length	
H 16 mm	H 13 mm				H 16 mm	H 16 mm				H 18 mm	H 18 mm			
10 Nm 87 lb.in	6 Nm 52 lb.in				10 Nm 87 lb.in	10 Nm 87 lb.in				15,5 Nm 134 lb.in	10 Nm 87 lb.in			
Type	Part numbers				Type	Part numbers				Type	Part numbers			
BAEH		th. 12 mm	1SNA 116 934	R0400	BAEH		th. 12 mm	1SNA 116 934	R0400	BAEH		th. 12 mm	1SNA 116 934	R0400
BADH		th. 12 mm	1SNA 116 900	R2700	BADH		th. 12 mm	1SNA 116 900	R2700	BADH		th. 12 mm	1SNA 116 900	R2700
BAMH		th. 9,1 mm	1SNA 114 836	R0000	BAMH		th. 9,1 mm	1SNA 114 836	R0000	BAMH		th. 9,1 mm	1SNA 114 836	R0000
ECS35			1SNA 168 841	R0300	ECS42			1SNA 168 843	R0500	ECS42			1SNA 168 843	R0500
PEP+RC610 for ECS					PEP+RC610 for ECS					PEP+RC610 for ECS				
RC610 for CPU					RC610 for CPU					RC610 for CPU				

D

3

M 400/52.EE1

Spacing 52 mm (2.05")
see size on following pages

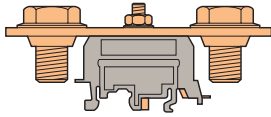

- 1 stud 40 x 6 with
- 2 screws HM16 for lug or bar
- 2 central bolts HM6 for transversal connection



Color	Type	Part number	Color	Type	Part number	Color	Type	Part number
Grey	<input type="checkbox"/>	M 400/52.EE1	1SNA 115 164	R1700				

Characteristics					Characteristics					Characteristics				
Wire size					Wire size					Wire size				
	DIN	NFC	UL	CSA		DIN	NFC	UL	CSA		DIN	NFC	UL	CSA
Lug	25-400 mm ²		00-500 MCM	600 MCM	Lug					Lug				
Bar		40 x 6 mm	1.57" x .24"		Bar					Bar				
Wire-clamp					Wire-clamp					Wire-clamp				
Voltage					Voltage					Voltage				
V~	Without partition				V~	Without partition				V~	Without partition			
	With partition	1000	1000	600	600		With partition				With partition			
Impulse withstand	8 kV	8 kV			Impulse withstand					Impulse withstand				
Pollution degree	3	3			Pollution degree					Pollution degree				
Current					Current					Current				
Rated	DIN	NFC			Rated	DIN	NFC			Rated	DIN	NFC		
	520 A		400 A	630 A										
Wire-size					Wire-size					Wire-size				
Rated	300 mm ²		500 MCM	600 MCM	Rated					Rated				
Lug	Central bolt	Wire-clamp	Wire stripping length		Lug	Central bolt	Wire-clamp	Wire stripping length		Lug	Central bolt	Wire-clamp	Wire stripping length	
H 24 mm	H 10 mm													
30 Nm 260 lb.in	4,5 Nm 39 lb.in													

Type	Part numbers			Type	Part numbers			Type	Part numbers		
BAEH	th. 12 mm	1SNA 116 934	R0400								
BADH	th. 12 mm	1SNA 116 900	R2700								
BAMH	th. 9,1 mm	1SNA 114 836	R0000								
ECS52		1SNA 168 840	R1600								

PEP+RC610 for ECS RC610 for CPU

ABB ENTRELEC's "positive retention" lock foot

Mounting

The locking action is automatic on mounting the block on the rail.

Unlocking

- Pull or push on the locking tag, using pliers as follows.
 - blocks mounted on DIN 1 rail: pull on the release tag.
 - blocks mounted on DIN 3 rails: push on the release tag.
- Remove the block from the rail by rotation, using a tube wrench while maintaining the action of the pliers.

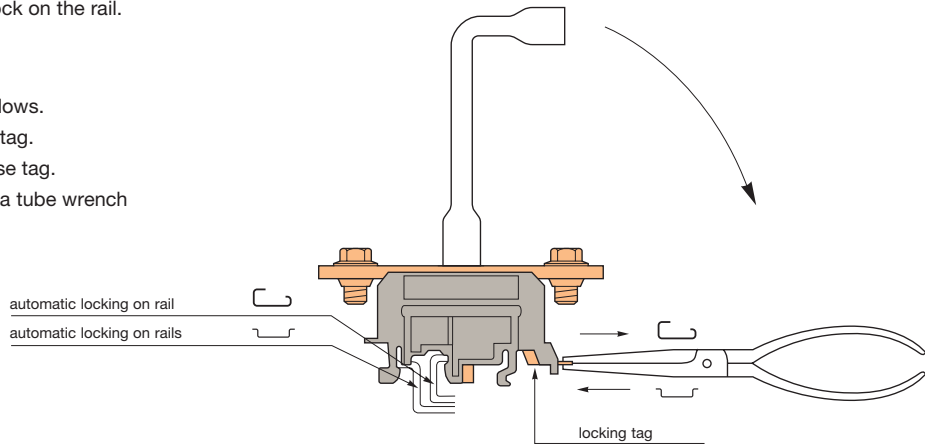

Space requirements of blocks with their partition or protective cover

Partitions for TYPE I blocks

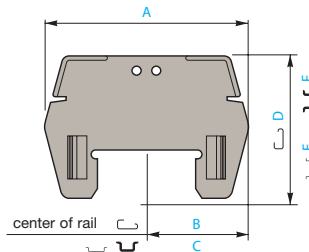
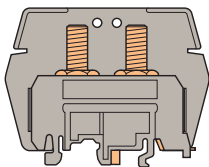

Type	Part number	Spac.	A	B	C	D	E	F
ECP26	1SNA 113 689 R2400	26	76	35,5	40,5	67,5	62,5	70
ECP31	1SNA 113 690 R2100	31	84	39,5	44,5	72,5	67,5	75
ECP35	1SNA 113 691 R1600	35	90	42,5	47,5	82,5	77,5	85
ECP42	1SNA 113 692 R1700	42	116	55,5	60,5	104,5	99,5	107

Partitions for TYPE II blocks

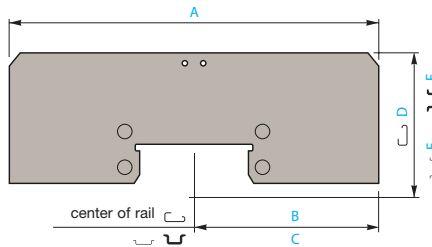
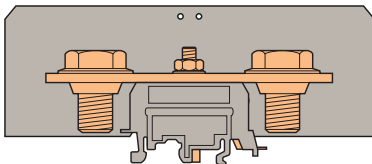

The spacing of the terminal blocks is not changed when partitions are used.

Type	Part number	A	B	C	D	E	F
ECS26	1SNA 168 838 F0000	170	82,5	87,5	72,5	67,5	75
ECS35	1SNA 168 841 F0300						
ECS42	1SNA 168 843 F0500						
ECS421	1SNA 168 844 F0600	260	127,5	132,5	82,5	77,5	85
ECS52	1SNA 168 840 F1600						
ECS31	1SNA 168 839 F0100	170	82,5	87,5	97,5	92,5	100
ECS351	1SNA 168 842 F0400						

Marker-holder for power blocks

PEP 1SNA 113 762 R2400

This marker-holder can receive :

1 label **RC610**

This marker-holder snaps on the **ECP** and **ECS** power blocks' partitions, as well as on the type I power blocks' compression clamps.

They can also be mounted on the **SCF** separator end sections.

