

SECTION A-A  
SCALE 4:1

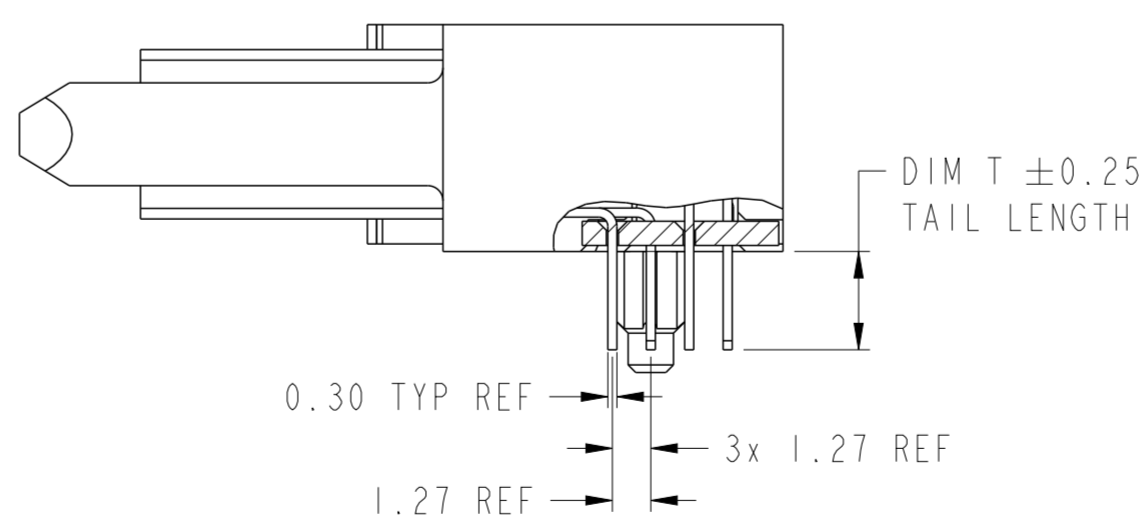

SECTION B-B  
SCALE 4:1

spec ref		-	dr		Julia Wang		2014/03/26		<div>Amphenol Power Solutions</div>			<div>MM</div>		scale		size	
tolerance std		TOLERANCES UNLESS OTHERWISE SPECIFIED	eng		Peter Hu		2022/03/15					4:1		A2			
ISO 406 ISO 1101			fwr		-		-		ec n no		ELX-DG-44139-1						
		appr		Zheng, Pei-Min		2022/03/21		A Division of Amphenol Corporation		amphenol-icc.com		rel level Released					
surface <div>ISO 1302</div>		linear	0.X		±0.5			title	HPCE BTB R/A RECPT				diag no	10125112		rev C	
			0.XX		±0.25												
			0.XXX		±0.10				CONFIG. P+S - UNIVERSAL DRAWING					cat. no.			
		angular	0°		±2°		product family		Product - Customer Drw				sheet 1 of 3				

TABLE 1 (HPCE / SOLDER TAILS)  
PLATED THROUGH-HOLE REQUIREMENTS

CONTACT TYPE	TOP LAYER DESCRIPTION	DRILLED HOLE DIAMETER	COPPER THICKNESS	TIN-LEAD THICKNESS	TIN THICKNESS	FINISHED HOLE DIAMETER
POWER & SIGNAL	TIN-LEAD	1.10-1.16 (1.15 DRILL)	0.025 - 0.050	0.005 - 0.015	--	0.94 - 1.10
	IMMERSION TIN	1.10-1.16 (1.15 DRILL)	0.025 - 0.050	--	0.9 - 1.5um	0.94 - 1.10
	COPPER (SEE NOTE 8)	1.10-1.16 (1.15 DRILL)	0.025 - 0.050	--	--	0.94 - 1.10

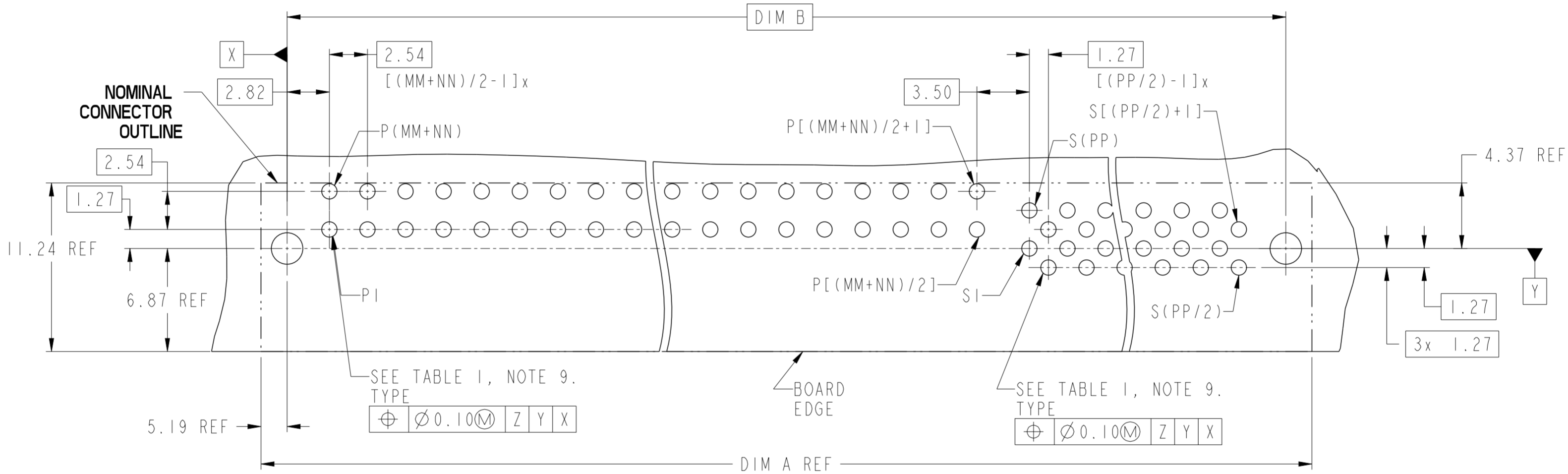

## RECOMMENDED PCB LAYOUT

spec ref		-		dr		Julia Wang		2014/03/26		<div>Amphenol Power Solutions</div>				<div>MM</div>		scale		size			
tolerance std		TOLERANCES UNLESS OTHERWISE SPECIFIED		eng		Peter Hu		2022/03/15						ec n no		ELX-DG-44139-1		4:1		A2	
ISO 406 ISO 1101				r v w r		-		-						rel level		Released					
				appr		Zheng, Pei-Min		2022/03/21		A Division of Amphenol Corporation				amphenolhcc.com							
surface		linear		0.X ±0.5 0.XX ±0.25 0.XXX ±0.10				title		HPCE BTB R/A RECPT CONFIG. P+S - UNIVERSAL DRAWING		diag no		10125112		rev		C			
ISO 1302		angular		0° ±2°						product family		Product - Customer Drw				sheet 2 of 3					

A  
B  
C  
D  
E  
F

10125112 - MM NN PP - LF  
LEAD FREE

DIM	TABLE 2. LENGTH FORMULAS
DIM A (11)	(MM + NN) / 2 x 2.54 + (PP / 2) x 1.27 + 16.02
DIM B	DIM A - 10.38
DIM T	2.60 OR 3.25 OR 4.85 OR 2.25

	NON-HALOGEN FREE								HALOGEN FREE							
	A	B	C	D	E	F	G	H	I	2	3	4	5	6	7	8
TAIL LENGTH(DIM D)	2.60		3.25		4.85		2.25		2.60		3.25		4.85		2.25	
HOLD-DOWN PEGS OPTION	Y	N	Y	N	Y	N	Y	N	Y	N	Y	N	Y	N	Y	N
STATE	TOOLED		TOOLED		TOOLED		NOT TOOLED		TOOLED		TOOLED		TOOLED		NOT TOOLED	

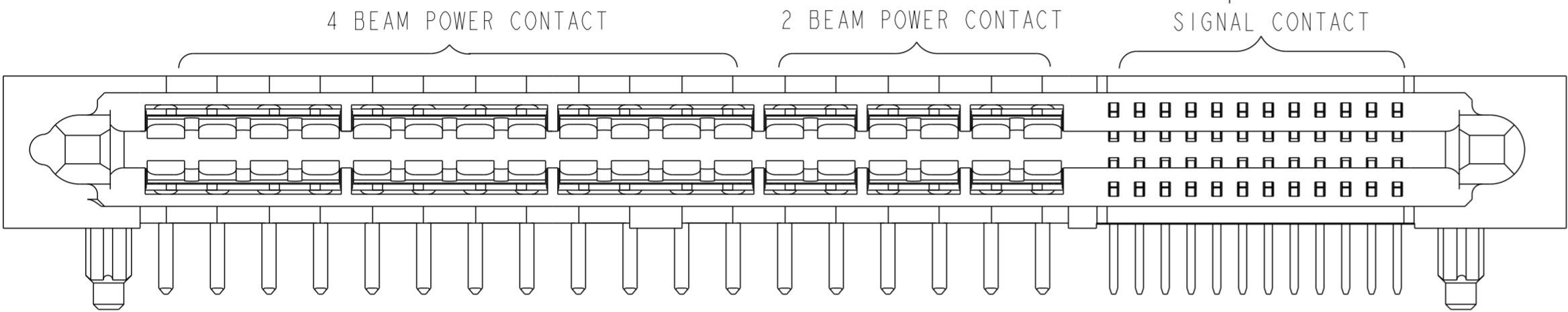

Example: The configuration above is 10125112-241224CLF  
STD HPCE BTB R/A REC 36P24S with Polarization Key and Hold-Down Pegs.  
24P is 4 beam contact, 12P is 2 beam contact.

TABLE 3: PART NUMBER CODE. HPCE BTB R/A RECPT P+S CONFIG

- NOTES:
- CONNECTOR MATERIALS:  
HOUSING: HIGH TEMPERATURE THERMAL PLASTIC, BLACK  
UL 94V-0 COMPLIANT  
CONTACTS: HIGH PERFORMANCE COPPER ALLOY.
  - CONTACT FINISH REF. GS-12-1125.
  - PRODUCT SPECIFICATION: GS-12-1125.
  - APPLICATION SPECIFICATION: GS-20-0388.
  - PRODUCT MARKING (FCI - PART NUMBER & DATE CODE) ON HOUSING IN AREA SHOWN.
  - PACKAGING MEETS FCI SPECIFICATION GS-14-2272.
  - HOUSING COMPONENT WILL WITHSTAND EXPOSURE TO 260°C PEAK TEMPERATURE FOR 60 SECONDS IN A CONVECTION, INFRA-RED, OR VAPOR PHASE REFLOW OVEN.
  - COPPER PLATING THICKNESS IN CENTER OF VIA-HOLE CAN BE NO MORE THAN 0.003 LESS THAN OTHER AREAS.
  - ALL HOLE SIZES ARE FINISHED HOLE SIZES.
  - MOUNTING HOLES ARE UNPLATED  
Ø 2.18 +/- 0.03 FOR SOLDER TAILS
  - MAXIMUM OVERALL LENGTH IS 100mm.

spec ref		-		dr		Julia Wang		2014/03/26		<div>Amphenol Power Solutions</div>			<div>MM</div>		scale		size			
tolerance std		ISO 406 ISO 1101		eng		Peter Hu		2022/03/15					ec n no		ELX-DG-44139-1		4:1		A2	
TOLERANCES UNLESS OTHERWISE SPECIFIED		r v w r		-		-		-					rel level		Released					
		appr		Zheng, Pei-Min		2022/03/21		A Division of Amphenol Corporation		amphenol-hcc.com										
surface		linear		0.X		±0.5		projection		title		HPCE BTB R/A RECPT		diag no		10125112		rev		
				0.XX		±0.25														
				0.XXX		±0.10														
		ISO 1302		angular		0°		±2°		product family		Product - Customer Drw		sheet 3 of 3						