

DASH NO.	M CODE	MADE FROM
----------	--------	-----------

SD

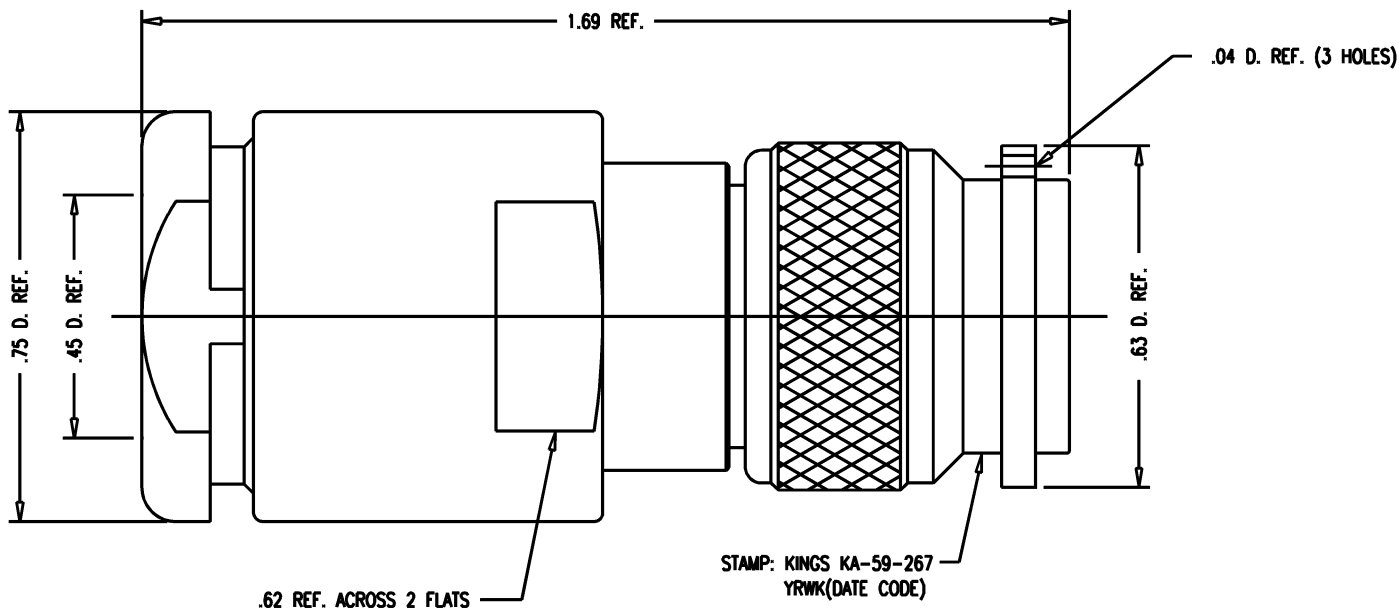

NOTES:

- FOR USE WITH RG-393/U CABLE.
- FOR CABLING INSTRUCTIONS SEE CP-230A.
- FOR CRIMPING USE DIE KTH-2004
- INTERFACE PER MIL-STD-348, FIG. 313-1.
- MARKING PACKAGE: KINGS KA-59-267  
YRWK(DATE CODE)
- WHEN USED WITH RG-9, 214, 225/U CABLE GROUPS,  
USE ONLY GASKET, VEE; OMIT OTHER.
- CONTACT MAY BE CRIMPED ON RG-225 & 393/U.  
BUT MUST BE SOLDERED ON RG-9 & 214/U CABLE.
- MATERIALS:  
INSULATORS: TEFLON, ASTM-D-4894  
K-GRIP SLEEVE: COMMERCIAL BRONZE, ASTM-B-135  
GASKETS: SILICONE RUBBER, ZZ-R-765  
OUTER CONTACT: BER. COP., ASTM-B-196  
ALL OTHER PARTS: BRASS, ASTM-B16
- FINISHES:  
ALL METAL PARTS: SILVER PLT. PER QQ-S-365
- ELECTRICAL CHARACTERISTICS:  
NOMINAL IMPEDANCE: 50 OHMS  
VOLTAGE RATING: 500 VRMS  
FREQUENCY RANGE: DC TO 11 GHz

KA-59-267

REVISIONS

ISSUE	CHANGES
4	CN 36607 E REDRAWN KH 10/04/95
5	CN 37569 C JW 03/25/98

KA59267S

SCALE 4:1

APPROX SURFACE AREA

USED ON

REF:

PLUG, TNC

DRAWN	KH	DATE	10/04/95
-------	----	------	----------

DESIGN	CT	DATE	10/05/95
--------	----	------	----------

APPR.	DATE
-------	------

**KINGS**  
ELECTRONICS CO., INC.  
TUCKAHOE, NEW YORK 10707

KA-59-267

SD