

För icke direkt toleranssatta mått gäller toleransklass
General tolerances if not otherwise stated

NOM DIM MM		TOL CLASS		
From	To	A	B	C
(1)	6	±0.05	±0.1	±0.2
(6)	30	±0.1	±0.2	±0.5
(30)	100	±0.15	±0.3	±0.8
(100)	300	±0.2	±0.5	±1.2
(300)	1000	±0.3	±0.8	±2

Hål / Holes H13

Skarpa kanter brutna där ej annat anges.
No sharp edges unless otherwise specified.

Övriga generella toleranser enligt ritning 4100-4644.
Additional general tolerances in accordance with drawing 4100-4644.

A - A

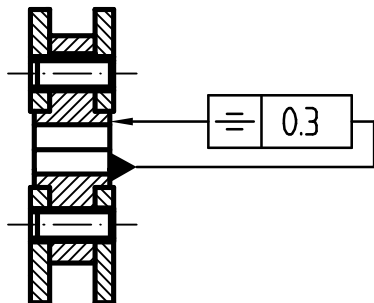

MÄRKT ENLIGT RITNING 4101-0270 A
MARKED IN ACCORDANCE WITH DRAWING 4101-0270 A

Rev	Change order	Change: A = Added W = Was D = Deleted	Date	Sign
2	1014994000	4101-0271 ÄNDRAD/CHANGED	021017	SE
3	1016252000	4101-0270A ÄNDRAD/CHANGED	030508	SE

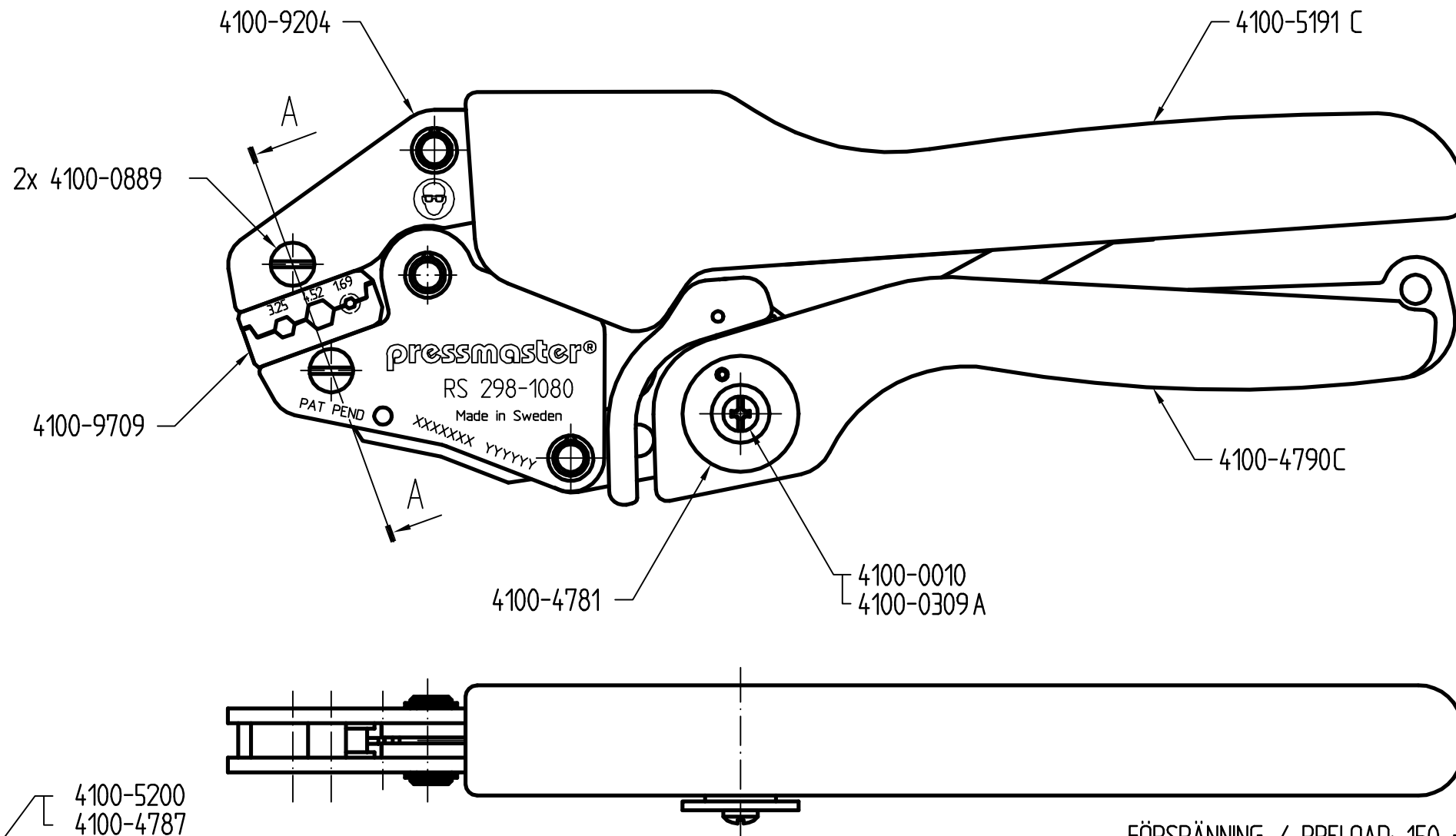

4101-0271
4100-5200
4100-4787

FÖRSPÄNNING / PRELOAD: 150 ± 40 N

Tolkmått / Gauge dimensions (mm)		
URTAG	Gåttolk	Stopptolk
NEST	GO	NO GO
HEX 3.25	∅ 3.20	∅ 3.30
HEX 4.52	∅ 4.47	∅ 4.57
HEX 1.69	∅ 1.64	∅ 1.74

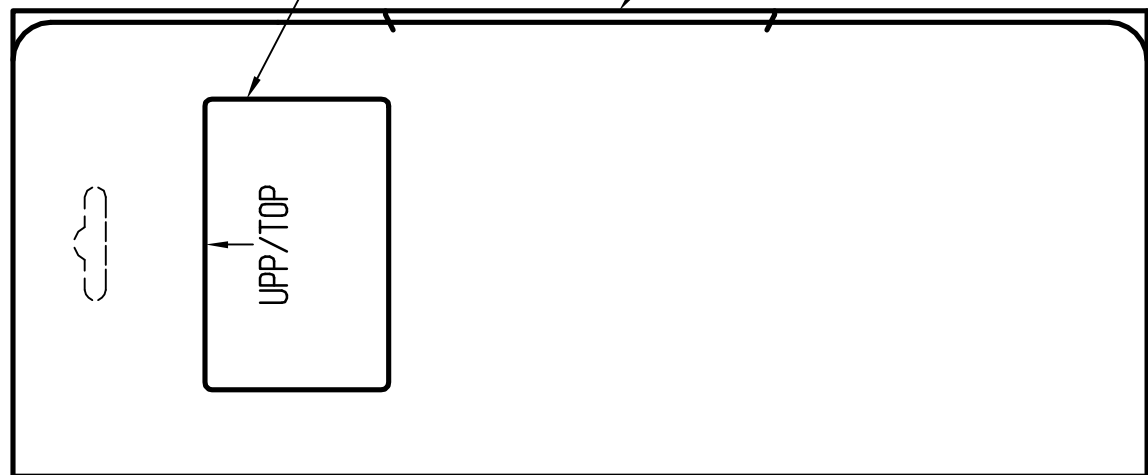

Denna ritning är Pressmaster AB:s egendom. Skyddad av gällande lag.
This drawing is the property of Pressmaster AB. Protected in accordance with prevailing law.

Material		Behandling/Treatment			Status	
Konstr./Design OS		Ritad/Drawn LJ	Datum/Date 980421	Skala/Scale 1:1	Kontr./Checked	Godk./Approved Prel.utc.
pressmaster® <small>ISO 9001 REG NR FM13687</small>				Benämning/Denomination KRIMPTÅNG 298-1080 CRIMPING TOOL		Vikt/Weight, gram Art grp 012
Ritn nr/Drawing no 43002439					REV 003	