



PART NO.

MC34315 Series

## REVISIONS

ECN #	REV	DESCRIPTION	DRAWN	DATE	CHECKD	DATE	APPRVD	DATE
-	A	RELEASED	Sidhu	28/2/11	Jagan	28/2/11	Farnell	14/3/11

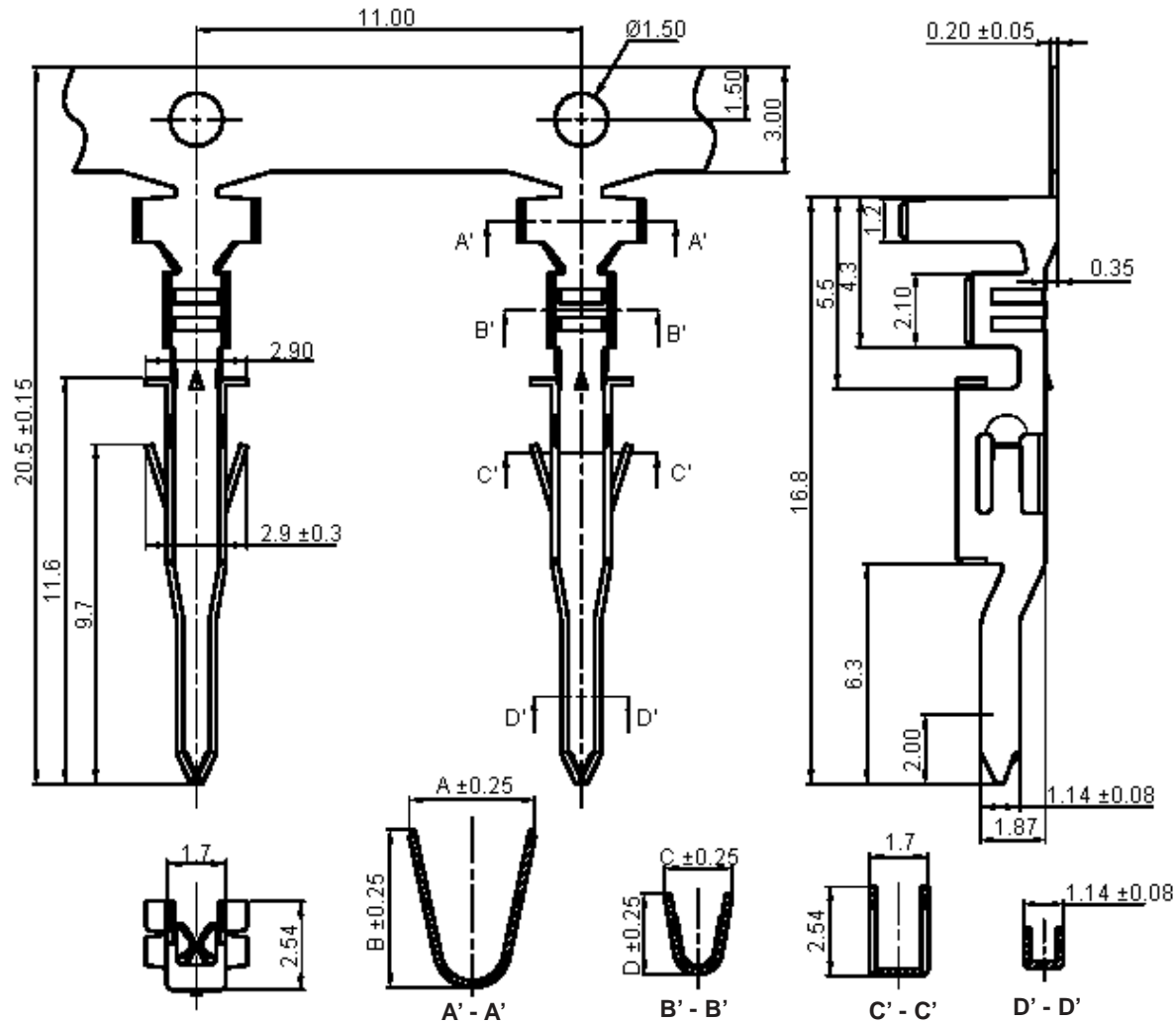

This data sheet and its contents (the "Information") belong to the Premier Farnell Group (the "Group") or are licensed to it. No licence is granted for the use of it other than for information purposes in connection with the products to which it relates. No licence of any intellectual property rights is granted. The Information is subject to change without notice and replaces all data sheets previously supplied. The Information supplied is believed to be accurate but the Group assumes no responsibility for its accuracy or completeness, any error in or omission from it or for any use made of it. Users of this data sheet should check for themselves the Information and the suitability of the products for their purpose and not make any assumptions based on information included or omitted. Liability for loss or damage resulting from any reliance on the Information or use of it (including liability resulting from negligence or where the Group was aware of the possibility of such loss or damage arising) is excluded. This will not operate to limit or restrict the Group's liability for death or personal injury resulting from its negligence. SPC MULTICOMP is the registered trademark of the Group. © Premier Farnell plc 2011.

## TOLERANCES:

UNLESS OTHERWISE SPECIFIED, DIMENSIONS ARE FOR REFERENCE PURPOSES ONLY.

DRAWN BY:

Sidhu

DATE:

28/02/11

CHECKED BY:

Jagan

DATE:

28/02/11

APPROVED BY:

Farnell

DATE:

14/03/11

DRAWING TITLE:

Crimp Pin - 4.2mm

SIZE  
A

DWG NO.

M10002637

ELECTRONIC FILE  
2259T\_DWGREV  
A

SCALE: NTS

U.O.M.: mm

SHEET: 1 OF 2



PART NO.

MC34315 Series

## REVISIONS

ECN #	REV	DESCRIPTION	DRAWN	DATE	CHECKD	DATE	APPRVD	DATE
-	A	RELEASED	Sidhu	28/2/11	Jagan	28/2/11	Farnell	14/3/11

## Specifications:

Current rating : 9.0 ac/dc.  
Voltage rating : 600V ac/dc.  
Maximum contact resistance : 10m ohm.  
Withstanding voltage : 1500V ac/minute.  
Operating temperature range : -40°C to 105°C.  
Application wires : 16 to 28 AWG.  
Mates with 2259 series housing.

## Material and Finish:

Contact : Brass or phosphor bronze.  
Finish : Tin plated.  
Packing : See table.

## Part Number Table

Description	Wire Apply	A	B	C	D	Part Number
Crimp Pin, 4.2mm, 22-28 AWG	22-28 AWG	2.3	2.3	1.8	1.65	MC343151
Crimp Pin, 4.2mm, 18-24 AWG	18-24 AWG	3.6	4.5	1.9	2.3	MC343152
Crimp Pin, 4.2mm, 16 AWG	16 AWG			2.3	2.7	MC343153

<http://www.farnell.com><http://www.newark.com><http://www.cpc.co.uk>

This data sheet and its contents (the "Information") belong to the Premier Farnell Group (the "Group") or are licensed to it. No licence is granted for the use of it other than for information purposes in connection with the products to which it relates. No licence of any intellectual property rights is granted. The Information is subject to change without notice and replaces all data sheets previously supplied. The Information supplied is believed to be accurate but the Group assumes no responsibility for its accuracy or completeness, any error in or omission from it or for any use made of it. Users of this data sheet should check for themselves the information and the suitability of the products for their purpose and not make any assumptions based on information included or omitted. Liability for loss or damage resulting from any reliance on the Information or use of it (including liability resulting from negligence or where the Group was aware of the possibility of such loss or damage arising) is excluded. This will not operate to limit or restrict the Group's liability for death or personal injury resulting from its negligence. SPC MULTICOMP is the registered trademark of the Group. © Premier Farnell plc 2011.

## TOLERANCES:

UNLESS OTHERWISE SPECIFIED, DIMENSIONS ARE FOR REFERENCE PURPOSES ONLY.

DRAWN BY:

Sidhu

DATE:

28/02/11

CHECKED BY:

Jagan

DATE:

28/02/11

APPROVED BY:

Farnell

DATE:

14/03/11

DRAWING TITLE:

Crimp Pin - 4.2mm

SIZE  
A

DWG NO.

M10002637

ELECTRONIC FILE  
2259T\_DWGREV  
A

SCALE: NTS

U.O.M.: mm

SHEET: 2 OF 2